

FGDOT PROJECT MANAGER, Robert Ayers (703) 877-5735 (FGDOT)
 SURVEYED BY, DATE DPWES, 05-09-08
 DESIGN SUPERVISED BY, Bharat Bhargava P.E. (703) 642-8100 (Volkert, Inc.)
 DESIGNED BY Volkert, Inc. (703) 642-8100
 SUBSURFACE UTILITY BY, DATE So-Deep, Inc. (703) 361-8005, 03-21-13

N/F
 FAIRFAX COUNTY
 PARK AUTHORITY
 D.B. 3371, PG. 743
 TAX MAP 092-1 ((01)) 0001

APPROX. LOCATION
 EX. 10' C & P TELE.
 CO. OF VIRGINIA ESMT.
 D.B. 4227, PG. 586

N/F
 THANH DUY VO, BA PHUC
 PHAN & DIEP NGOC PHAN
 D.B. 10476, PG. 908

N/F
 JONG DUK KIM
 & JUNG JA KIM
 D.B. 5012, PG. 199

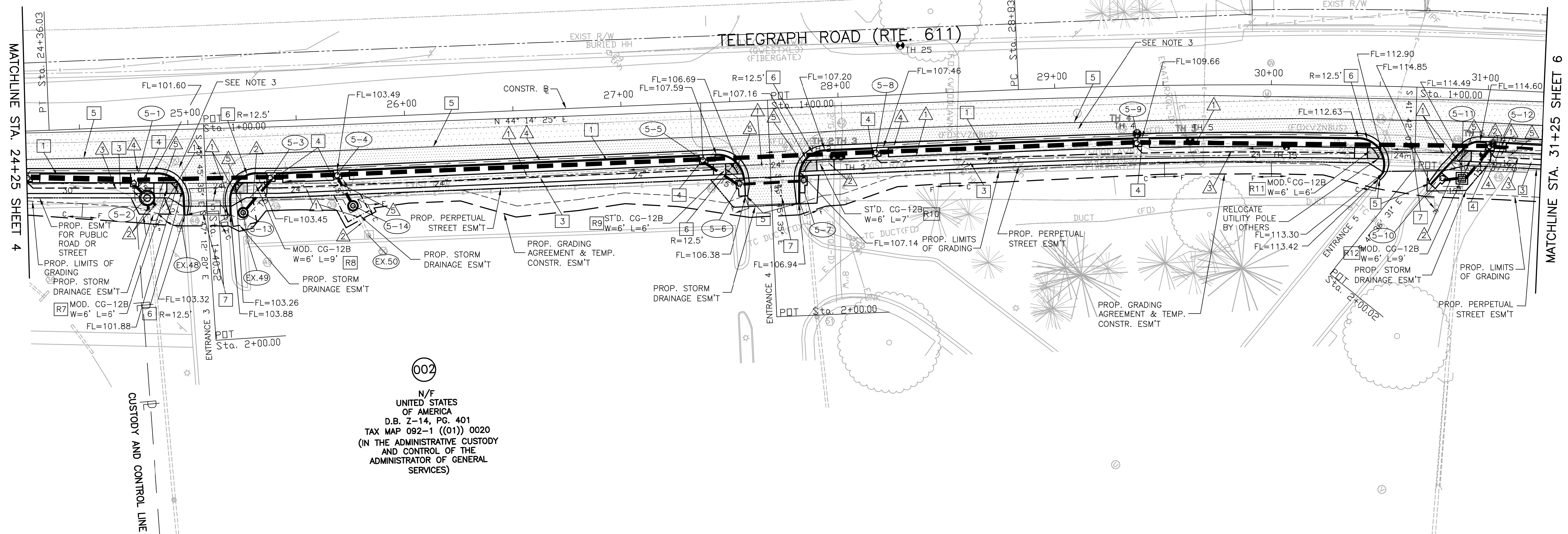

002
 N/F
 UNITED STATES
 OF AMERICA
 D.B. 7-14, PG. 401
 TAX MAP 092-1 ((01)) 0020
 (IN THE ADMINISTRATIVE CUSTODY
 AND CONTROL OF THE
 ADMINISTRATOR OF GENERAL
 SERVICES)

DRAINAGE LEGEND

- ▲ DENOTES EXISTING PIPE TO BE REMOVED
- ▲ DENOTES PROPOSED PIPE TO BE FLUSHED AND CLEANED OUT
- ▲ ST'D. UD-3
- ▲ ST'D. UD-4
- ▲ DENOTES EXISTING STRUCTURE TO BE REMOVED

DESIGN LEGEND

- 1 ST'D. CG-6
- 3 6' CONCRETE SIDEWALK
- 4 BUILD PROPOSED SIDEWALK FLUSH WITH DROP INLET
- 5 SAWCUT
- 6 ST'D. RAD. CG-6
- 7 MOD. EXISTING CG-11 ENTRANCE
- DENOTES FULL DEPTH PAVEMENT (EXISTING PAVEMENT TO BE REMOVED)
- DENOTES MILL/OVERLAY SECTION

NOTES:

1. FL STANDS FOR FLOW LINE ELEVATION AT BOTTOM OF CURB.
2. ALL PROPOSED PIPES SHALL BE FLUSHED AND CLEANED OUT.
3. CONTRACTOR SHALL RESET SANITARY SEWER MANHOLES TO PROPOSED GRADE. PAYMENT FOR RESETTING MANHOLE FRAMES WILL BE MADE AT CONTRACT UNIT PRICE PER EACH, AND WILL INCLUDE ALL LABOR, MATERIALS, TOOLS, EQUIPMENT AND INCIDENTALS NEEDED TO COMPLETE THE WORK.
4. CONTRACTOR WILL BE RESPONSIBLE TO HAVE PROPERTY MONUMENTATION REPLACED UNDER SUPERVISION OF A LICENSED LAND SURVEYOR IN THE EVENT THE MONUMENTATION IS DISTURBED OR REMOVED.

- Ⓚ SANITARY MANHOLE
TOP = 101.86
INV. OUT 8" = 94.46
INV. IN 8" = 94.56
- Ⓛ SANITARY MANHOLE
TOP = 109.20
INV. OUT 8" = 98.67
INV. IN 8" (NE) = 98.82
INV. IN 8" (E) = 99.12
INV. IN 8" (SE) = 99.09
- Ⓜ SANITARY MANHOLE
TOP = 112.00
INV. OUT 8" = 98.97
INV. IN 8" = 99.02
- Ⓝ HEADWALL
TOP = 103.42
12" INV. IN = 101.38
- Ⓞ ENDWALL
TOP = 102.92
24" INV. OUT = 98.54
15" INV. OUT = 98.35
12" INV. OUT = 98.47
- Ⓟ GRATE INLET
TOP = 103.23
24" INV. OUT = 98.83
24" INV. IN = 98.92
12" INV. IN = 99.01
- Ⓠ STORM DRAIN MANHOLE
TOP = 104.26
24" INV. OUT = 99.73
21" INV. IN = 99.76
15" INV. IN = 99.64
- Ⓡ CURB INLET
TOP = 106.36
21" INV. OUT = 102.28
21" INV. IN = 102.44
- Ⓢ CURB INLET
TOP = 106.43
21" INV. OUT = 102.57
15" INV. IN = 103.00
15" INV. IN = 102.93
- Ⓣ GRATE INLET
TOP = 106.17
15" INV. OUT = 103.62
15" INV. IN = 103.57
- Ⓤ GRATE INLET
TOP = 109.29
15" INV. OUT = 106.75
21" INV. IN = 106.64
- Ⓡ CURB INLET
TOP = 113.04
15" INV. OUT = 108.38
21" INV. IN = 108.63
- Ⓢ CURB INLET
TOP = 114.34
21" INV. OUT = 109.19
18" INV. IN = 109.22
18" INV. IN = 110.28
- Ⓣ HEADWALL
TOP = 112.54
18" INV. IN = 109.51
- Ⓤ STORM DRAIN MANHOLE
TOP = 111.40
15" INV. OUT = 102.20
15" INV. IN = 105.72
- Ⓡ CURB INLET
TOP = 104.40
12" INV. OUT = 99.70
- Ⓢ CURB INLET
TOP = 105.68
12" INV. OUT = 101.04
- Ⓣ CURB INLET
TOP = 105.75
12" INV. OUT = 100.27
- Ⓤ CURB INLET
TOP = 109.88
15" INV. OUT = 104.45
15" INV. IN = 106.15
- Ⓡ GRATE INLET
TOP = 116.82
18" INV. OUT = 110.45
15" INV. IN = 111.87
- Ⓢ CURB INLET
TOP = 109.88
15" INV. OUT = 104.45
15" INV. IN = 106.15
- Ⓣ GRATE INLET
TOP = 116.82
18" INV. OUT = 110.45
15" INV. IN = 111.87
- Ⓤ CURB INLET
TOP = 114.34
21" INV. OUT = 109.19
18" INV. IN = 109.22
18" INV. IN = 110.28

- Ⓟ-2 TO Ⓟ-1 5'-15" CONC. PIPE REQ'D.
COVER = 3'
INV IN = 97.25 (5-2)
INV OUT = 97.13 (5-1)
- Ⓟ-2 4.6 L.F. ST'D. MH-1 OR 2 REQ'D.
1 ST'D. MH-1 FRAME & COVER REQ'D.
INV = 97.25 TOP = 101.85
ST'D. IS-1 REQ'D.
- EX.47 TO Ⓟ-2 135'-15" CONC. PIPE REQ'D.
COVER = 2'
INV IN = 102.2 (EX. 47)
INV OUT = 98.29 (5-2)
- EX.48 TO Ⓟ-2 17'-15" CONC. PIPE REQ'D.
COVER = 2'
INV IN = 99.70 (EX. 48)
INV OUT = 99.32 (5-2)
- Ⓟ-3 TO Ⓟ-1 61'-24" CONC. PIPE REQ'D.
COVER = 3'
INV IN = 97.37 (5-3)
INV OUT = 96.40 (5-1)
- Ⓟ-13 TO Ⓟ-3 20'-15" CONC. PIPE REQ'D.
COVER = 2'
INV IN = 99.79 (5-13)
INV OUT = 99.39 (5-3)
- EX.49 TO Ⓟ-13 13'-12" RCP PIPE REQ'D.
COVER = 2'
INV IN = 101.04 (EX. 49)
INV OUT = 99.89 (5-13)
- Ⓟ-3 1 ST'D. DI-3B REQ'D.
INV = 97.31 TOP = 103.36
H = 6.1', L = 8'
CONNECT UD-3 & UD-4 TO DI
- Ⓟ-13 4.0 L.F. ST'D. MH-1 OR 2 REQ'D.
1 ST'D. MH-1 FRAME & COVER REQ'D.
INV = 100.16 TOP = 104.33
ST'D. IS-1 REQ'D.
- Ⓟ-14 4.2 L.F. ST'D. MH-1 OR 2 REQ'D.
1 ST'D. MH-1 FRAME & COVER REQ'D.
INV = 100.09 TOP = 104.88
ST'D. IS-1 REQ'D.

- Ⓟ-4 TO Ⓟ-3 29'-24" CONC. PIPE REQ'D.
COVER = 4'
INV IN = 97.88 (5-4)
INV OUT = 97.47 (5-3)
- Ⓟ-4 1 ST'D. DI-3B REQ'D.
INV = 97.88 TOP = 103.99
H = 6.1', L = 6'
CONNECT UD-3 & UD-4 TO DI
- Ⓟ-14 TO Ⓟ-4 15'-15" RCP PIPE REQ'D.
COVER = 3'
INV IN = 100.10 (5-14)
INV OUT = 100.02 (5-4)
- EX.50 TO Ⓟ-14 15'-15" CONC. PIPE REQ'D.
COVER = 3'
INV IN = 100.27 (EX. 50)
INV OUT = 100.20 (5-14)
- Ⓟ-5 TO Ⓟ-4 166'-24" CONC. PIPE REQ'D.
COVER = 6'
INV IN = 100.45 (5-5)
INV OUT = 97.98 (5-4)
- Ⓟ-5 1 ST'D. DI-3B REQ'D.
INV = 100.45 TOP = 107.14
H = 6.7', L = 6'
ST'D. IS-1 REQ'D.
- Ⓟ-6 TO Ⓟ-5 19'-15" CONC. PIPE REQ'D.
COVER = 5'
INV IN = 102.93 (5-6)
INV OUT = 102.56 (5-5)
- Ⓟ-6 MOD. DI-3B REQ'D.
INV = 102.93 TOP = 106.53
H = 3.6', L = 6'
MODIFY TO ACCEPT 15" EX. CMP PIPE

- Ⓟ-7 TO Ⓟ-6 26'-15" CONC. PIPE REQ'D.
COVER = 2'
INV IN = 103.30 (5-7)
INV OUT = 103.03 (5-6)
- Ⓟ-7 MOD. DI-3B REQ'D.
INV = 103.30 TOP = 106.40
H = 3.1', L = 8'
MODIFY TO ACCEPT 15" EX. CMP PIPE
- Ⓟ-8 TO Ⓟ-5 77'-24" CONC. PIPE REQ'D.
COVER = 6'
INV IN = 102.46 (5-8)
INV OUT = 100.55 (5-5)
- Ⓟ-8 1 ST'D. DI-3B REQ'D.
INV = 102.46 TOP = 107.93
H = 5.5', L = 6'
CONNECT UD-3 & UD-4 TO DI
- Ⓟ-9 TO Ⓟ-8 123'-24" CONC. PIPE REQ'D.
COVER = 3'
INV IN = 105.26 (5-9)
INV OUT = 102.56 (5-8)
- Ⓟ-9 1 ST'D. DI-3B REQ'D.
INV = 105.26 TOP = 110.16
H = 4.9', L = 8'
CONNECT UD-3 & UD-4 TO DI
- Ⓟ-12 TO Ⓟ-9 160'-15" CONC. PIPE REQ'D.
COVER = 5'
INV IN = 109.18 (5-12)
INV OUT = 103.03 (5-9)
- Ⓟ-10 1 ST'D. DI-3B REQ'D.
INV = 110.85 TOP = 115.35
H = 4.5', L = 8'
ST'D. IS-1 REQ'D.
- Ⓟ-10 TO Ⓟ-11 7'-15" CONC. PIPE REQ'D.
COVER = 3'
INV IN = 110.85 (5-10)
INV OUT = 110.21 (5-11)
- Ⓟ-11 ST'D. DI-1 REQ'D.
INV = 109.85 TOP = 114.35
H = 4.5'
MODIFY TO ACCEPT 18" EX. CMP PIPE
- Ⓟ-11 TO Ⓟ-12 18'-15" CONC. PIPE REQ'D.
COVER = 5'
INV IN = 109.85 (5-11)
INV OUT = 109.38 (5-12)
- EX.48 MODIFY EXISTING CURB INLET
TOP = 104.40
12" INV OUT = 99.70
MODIFY TO REMOVE 12" CONC. PIPE
MODIFY TO ACCEPT 15" CONC. PIPE
PROP. 15" INV OUT = 99.70
- EX.49 MODIFY EXISTING CURB INLET
TOP = 105.68
12" INV OUT = 101.04
MODIFY TO REMOVE 12" CONC. PIPE
MODIFY TO ACCEPT 15" CONC. PIPE
PROP. 15" INV OUT = 101.04
- EX.50 MODIFY EXISTING CURB INLET
TOP = 105.75
12" INV OUT = 100.27
MODIFY TO REMOVE 12" CONC. PIPE
MODIFY TO ACCEPT 15" CONC. PIPE
PROP. 15" INV OUT = 100.27

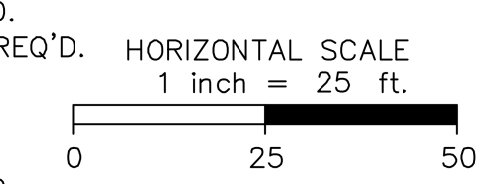

COMMONWEALTH OF VIRGINIA
 PROFESSIONAL ENGINEER
 JASON M. PISANI
 Lic. No. 51500
 Jason M. 2019.12.19
 Jimenez-Pisani 14:58:28 -05'00'
 Volkert, Inc.
 Alexandria, Virginia
 Civil Engineer

EMERGENCY POLICE - FIRE - RESCUE 911

FAIRFAX COUNTY, VIRGINIA
 DEPARTMENT OF PUBLIC WORKS AND ENVIRONMENTAL SERVICES
 UTILITIES DESIGN & CONSTRUCTION DIVISION
 12000 GOVERNMENT CENTER PARKWAY, SUITE 449 FAIRFAX, VA., 22035-0052

| | | | | |
|--|--|-------------------|-----------------|------------------|
| | | | | |
| OFFICE OF CAPITAL FACILITIES 703-324-5800 | TELEGRAPH ROAD WALKWAY WALKWAY PLAN | | | |
| CONTRACT NO. 20304178 | PROJECT NO. ST-000021-023 | SCALE 1" = 25' | DESIGNED BY: PK | SHEET 5 OF 12 |
| DESIGNED BY: MW | CHECKED BY: BB | BY | APPROVED | DATE |

FUND# 300-C30050