

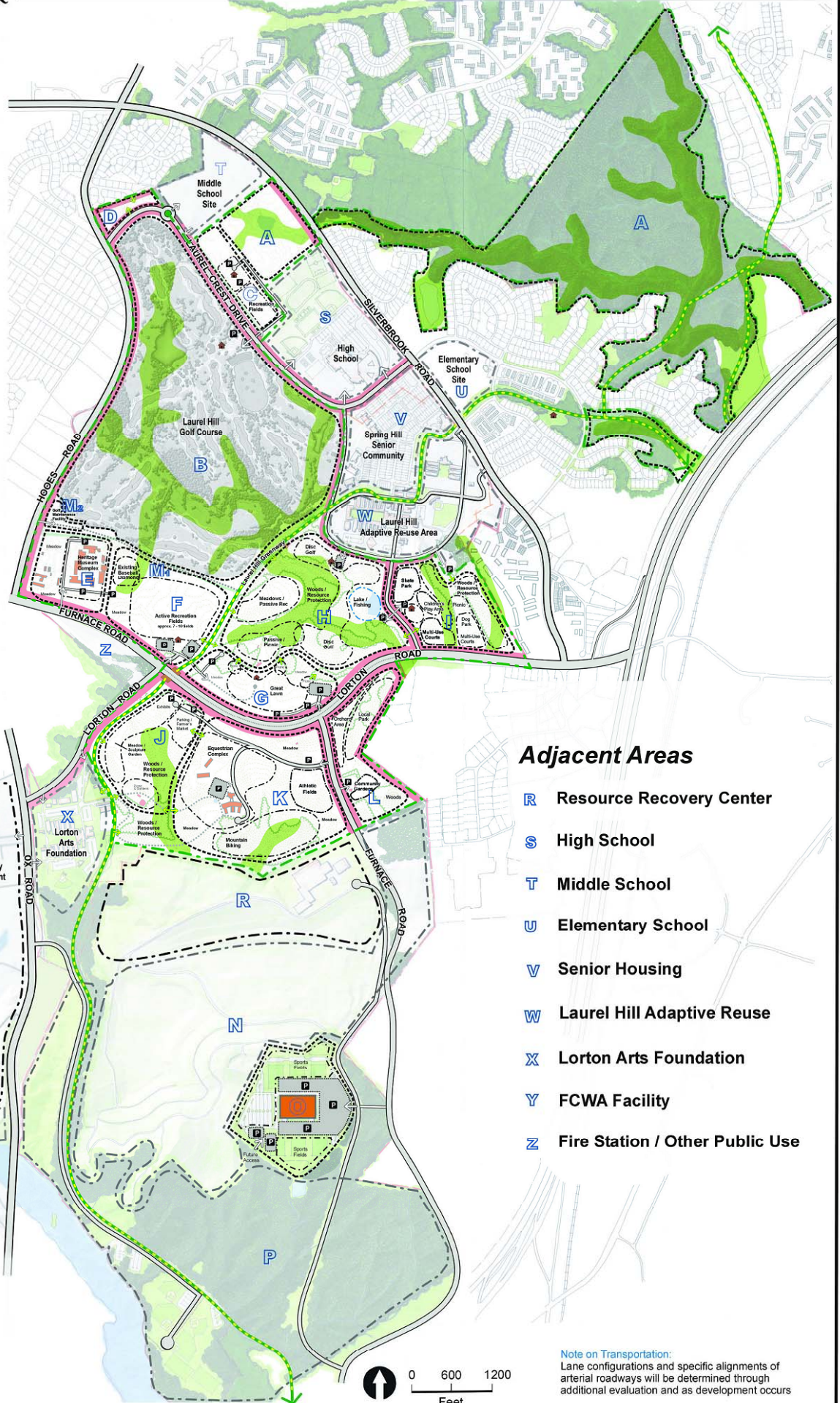

Public Land Use

- A** Resource Management Area
- B** Laurel Hill Golf Course
- C** Nike Recreation Area
- D** Crosspointe Area Park
- E** Heritage Area
- F** Heritage Recreation Area
- G** Central Green
- H** Giles Run Meadow
- I** Community Park
- J** Workhouse Hills
- K** Equestrian Center
- L** Apple Orchard Recreation Area
- M₁** Park Maintenance Facility
- M₂** Golf Course Maintenance Facility
- N** Future Land Fill Park
- O** Sports Complex
- P** Expanded Occoquan Regional Park
- Q** Vulcan Quarry / Future Park



Adjacent Areas

- R** Resource Recovery Center
- S** High School
- T** Middle School
- U** Elementary School
- V** Senior Housing
- W** Laurel Hill Adaptive Reuse
- X** Lorton Arts Foundation
- Y** FCWA Facility
- Z** Fire Station / Other Public Use

- Non-Vehicular Entry
- Vehicular Entry
- Facility / Structure
- Park Sub-Area
- Park Area
- Other Public Areas
- Resource Protection
- 50 ft Development Setback Line
- Laurel Hill Greenway
- Other Trail / Path
- Parking

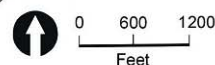

Note on Transportation:
Lane configurations and specific alignments of arterial roadways will be determined through additional evaluation and as development occurs