

VICINITY MAP  
Scale: 1" = 200'  
TM 21-4-631-747A

Flood Plan Boundaries

Sta	North	East	Width	Dist
A	2145.221	4160.255	252' 10" E	26.84
B	2090.00	4177.00	221' 42" E	25.60
C	4775.00	4177.00	221' 42" W	36.67
D	4775.00	4160.255	221' 42" W	47.67
E	4775.00	4160.255	221' 42" W	36.67
F	4775.00	4160.255	221' 42" W	36.67
G	4775.00	4160.255	221' 42" W	36.67
H	4775.00	4160.255	221' 42" W	36.67
I	4775.00	4160.255	221' 42" W	36.67
J	4775.00	4160.255	221' 42" W	36.67
K	4775.00	4160.255	221' 42" W	36.67
L	4775.00	4160.255	221' 42" W	36.67
M	4775.00	4160.255	221' 42" W	36.67
N	4775.00	4160.255	221' 42" W	36.67
O	4775.00	4160.255	221' 42" W	36.67
P	4775.00	4160.255	221' 42" W	36.67

E 5200  
E 5100  
E 5000  
E 4900  
E 4800  
E 4700  
E 4600

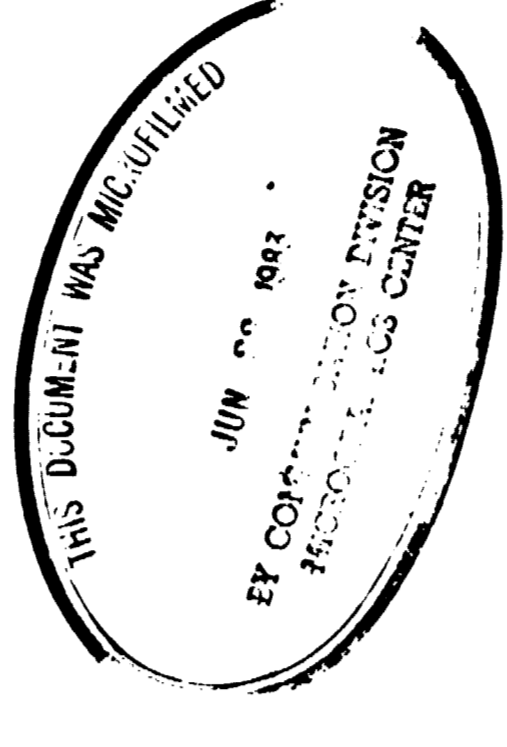
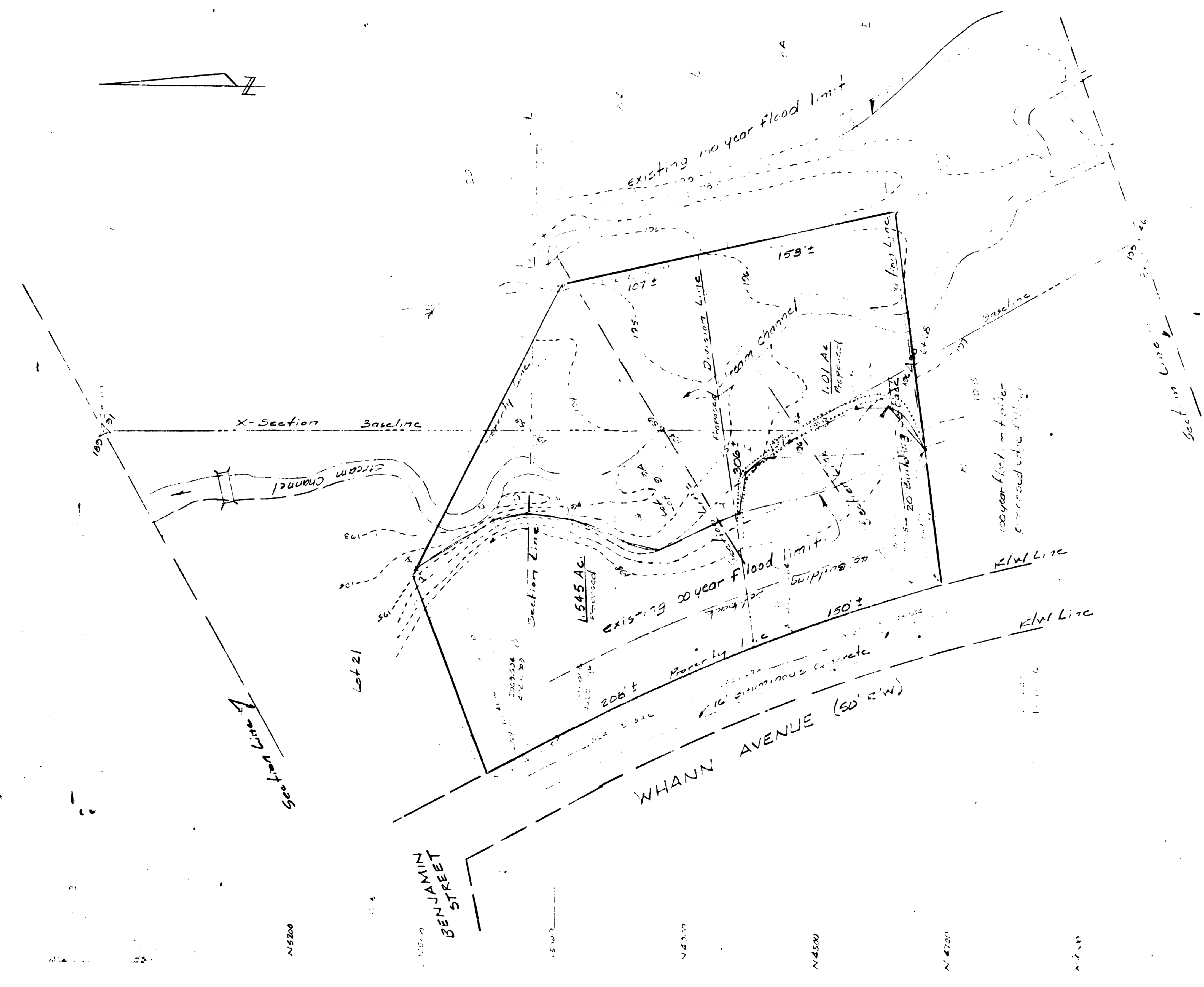

GENERAL NOTES  
- Existing 100 year flood limit shown  
- Existing 20 year flood limit shown  
- R/W Line shown  
- Baseline shown  
- Section Line shown  
- Lot Lines shown  
- Building Footprints shown  
- Elevation of ground surface shown  
- Elevation of flood surface shown  
- Elevation of R/W Line shown  
- Elevation of Baseline shown  
- Elevation of Section Line shown  
- Elevation of Lot Lines shown  
- Elevation of Building Footprints shown

Michael S. Stuck III  
3007 Chalfont Ave.  
Fort Washington, Md 20744  
Ph: 202-5612

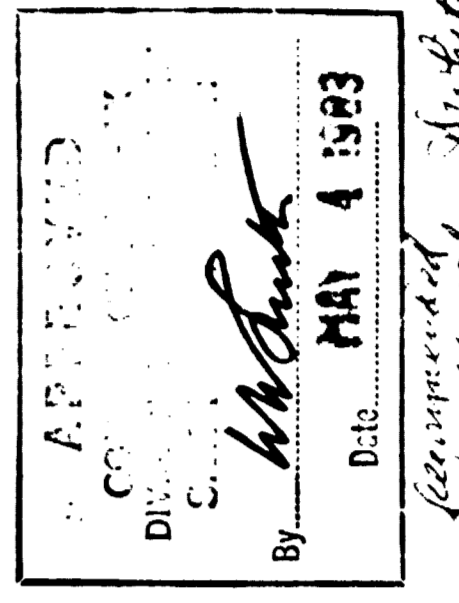

DESIGN REVIEW COPY

2/10  
1/22

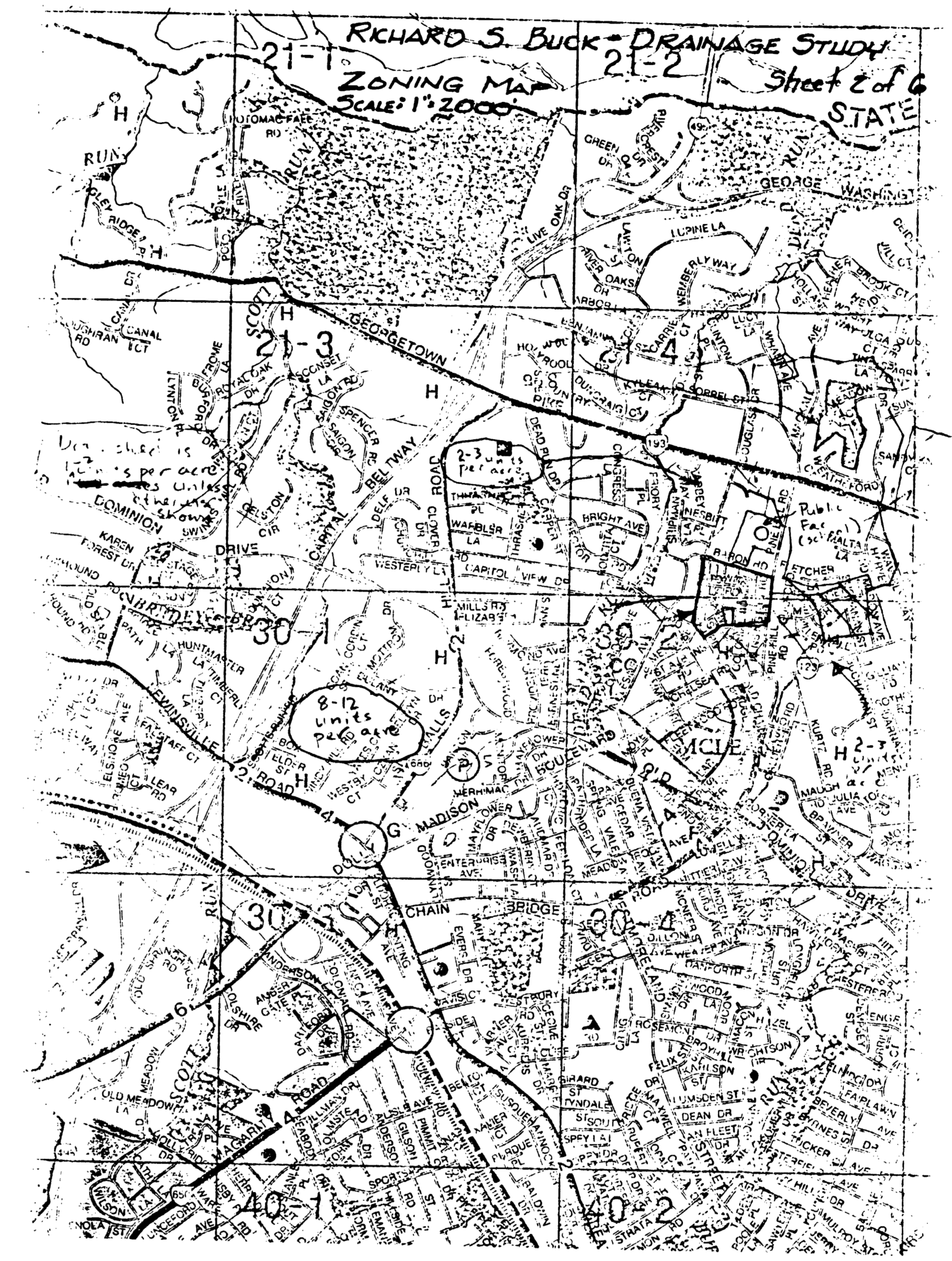
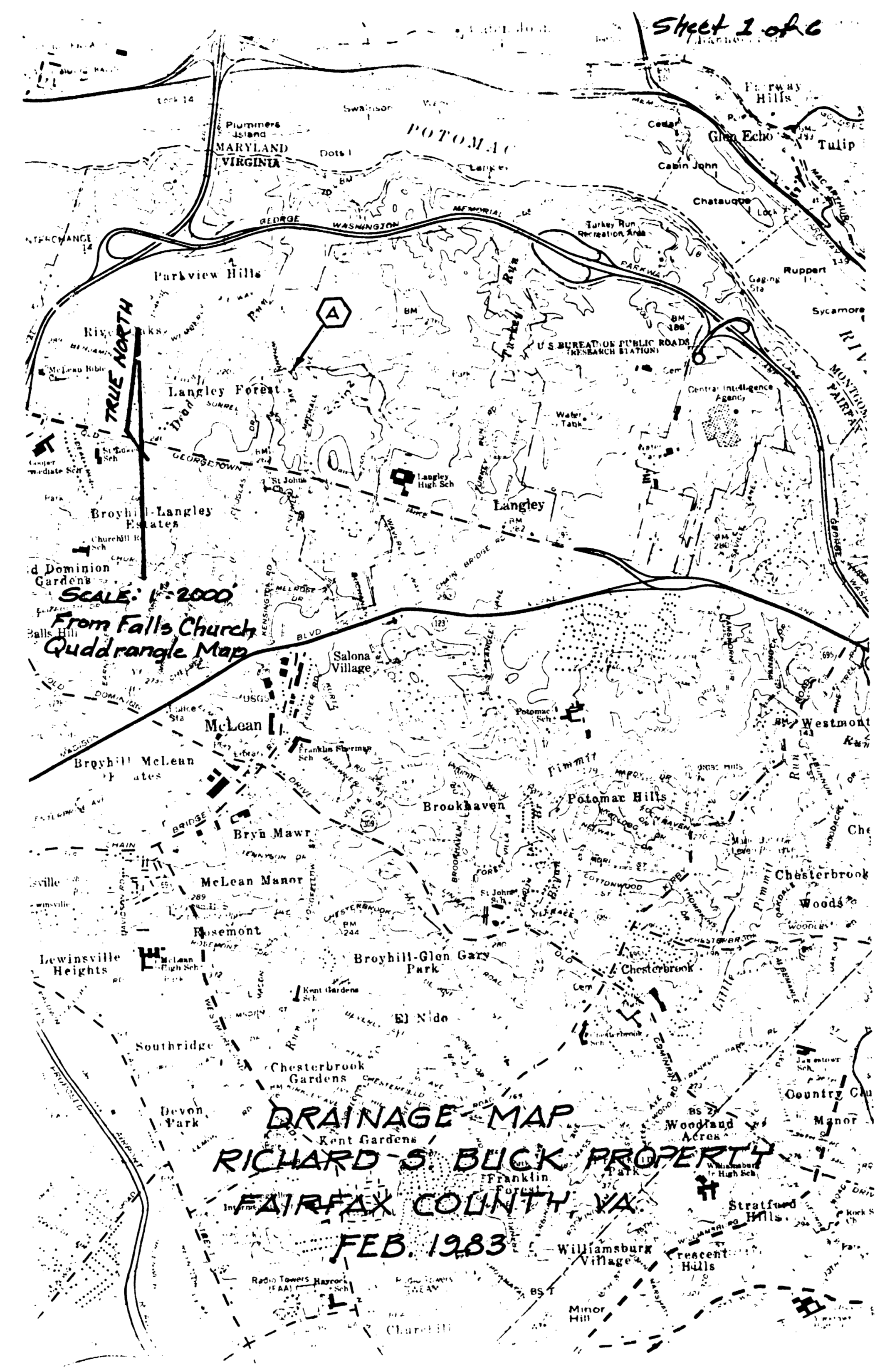



1. The following information was obtained from the files of the FBI, New York Office, on the subject of the above captioned case:

On 1/25/68, the New York Office received a letterhead memorandum (LHM) from the New York Office of the FBI, dated 1/25/68, captioned as above. The LHM advised that the New York Office had received information from the New York Office of the FBI, dated 1/25/68, captioned as above. The LHM advised that the New York Office had received information from the New York Office of the FBI, dated 1/25/68, captioned as above.

On 1/25/68, the New York Office received a letterhead memorandum (LHM) from the New York Office of the FBI, dated 1/25/68, captioned as above. The LHM advised that the New York Office had received information from the New York Office of the FBI, dated 1/25/68, captioned as above.

On 1/25/68, the New York Office received a letterhead memorandum (LHM) from the New York Office of the FBI, dated 1/25/68, captioned as above. The LHM advised that the New York Office had received information from the New York Office of the FBI, dated 1/25/68, captioned as above.

On 1/25/68, the New York Office received a letterhead memorandum (LHM) from the New York Office of the FBI, dated 1/25/68, captioned as above. The LHM advised that the New York Office had received information from the New York Office of the FBI, dated 1/25/68, captioned as above.

On 1/25/68, the New York Office received a letterhead memorandum (LHM) from the New York Office of the FBI, dated 1/25/68, captioned as above. The LHM advised that the New York Office had received information from the New York Office of the FBI, dated 1/25/68, captioned as above.

On 1/25/68, the New York Office received a letterhead memorandum (LHM) from the New York Office of the FBI, dated 1/25/68, captioned as above. The LHM advised that the New York Office had received information from the New York Office of the FBI, dated 1/25/68, captioned as above.

On 1/25/68, the New York Office received a letterhead memorandum (LHM) from the New York Office of the FBI, dated 1/25/68, captioned as above. The LHM advised that the New York Office had received information from the New York Office of the FBI, dated 1/25/68, captioned as above.

On 1/25/68, the New York Office received a letterhead memorandum (LHM) from the New York Office of the FBI, dated 1/25/68, captioned as above. The LHM advised that the New York Office had received information from the New York Office of the FBI, dated 1/25/68, captioned as above.

On 1/25/68, the New York Office received a letterhead memorandum (LHM) from the New York Office of the FBI, dated 1/25/68, captioned as above. The LHM advised that the New York Office had received information from the New York Office of the FBI, dated 1/25/68, captioned as above.

This document was prepared by the New York Office of the FBI, dated 1/25/68, captioned as above.

THIS DOCUMENT WAS MICROFILMED  
 JUN 22 1983  
 BY COMMUNICATION DIVISION  
 MICROFILM CENTER

THIS DOCUMENT WAS MICROFILMED  
 JUN 22 1983  
 BY COMMUNICATION DIVISION  
 MICROFILM CENTER

THIS DOCUMENT WAS MICROFILMED  
 JUN 22 1983  
 BY COMMUNICATION DIVISION  
 MICROFILM CENTER

After edge filling

FLAND PLAINS CONVEYANCE Richard S. Gaudet  
G. Langley Forest

Sheet 3

Station	Area	Vol. (cu ft)	Vol. (cu yd)	Dist. (ft)	Dist. (yd)	Area (sq ft)	Area (sq yd)	Vol. (cu ft)	Vol. (cu yd)
3+75	195.22	303.4	0.11	195.33	1488	2.01	0.015	0.015	3.25
4+26	196.48	419.8	0.06	196.54	1461	1.76	0.009	0.012	1.01
5+28	197.44	310.7	0.011	197.51	1714	2.067	0.010	0.0095	1.02
6+28	198.58	382.7	0.07	198.65	139	1.55	0.013	0.012	1.00
8+28	201.02	368.4	0.07	201.09	155	1.79	0.011	0.012	2.00
0+92									2.40
									0.01
									2.01
									192.41
									192.55
									0.97
									0.01
									197.82
									192.68
									2.40
									0.01
									2.01
									201.06

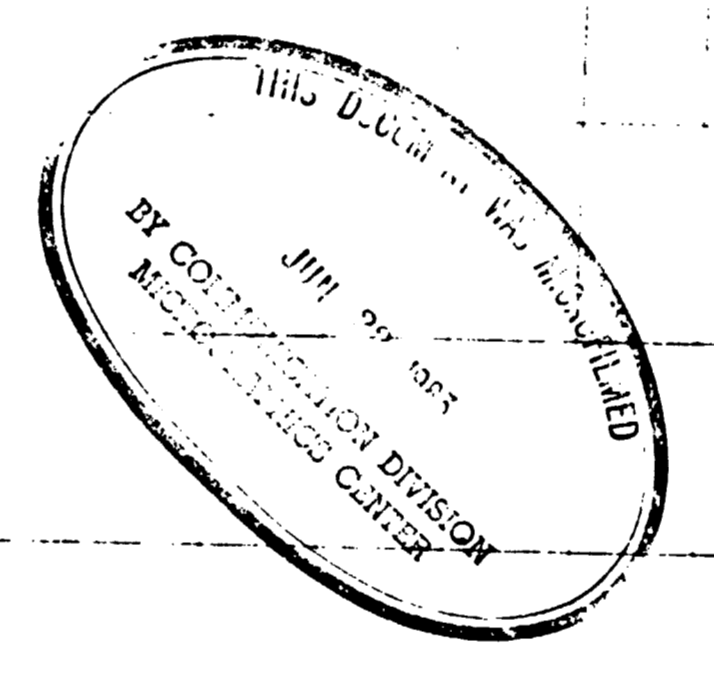

Before edge filling

FLAND PLAINS CONVEYANCE Richard S. Gaudet  
G. Langley Forest

Sheet 2

Station	Area	Vol. (cu ft)	Vol. (cu yd)	Dist. (ft)	Dist. (yd)	Area (sq ft)	Area (sq yd)	Vol. (cu ft)	Vol. (cu yd)
0+00	191.04	398.2	0.06	191.10	152	0.011	0.011	0.011	3.65
3+25	195.22	303.4	0.11	195.33	1488	2.01	0.015	0.013	3.65
4+26	196.48	419.8	0.06	196.54	1461	1.76	0.009	0.012	1.01
5+28	197.44	382.7	0.06	197.50	152	1.75	0.010	0.010	1.02
6+28	198.58	382.7	0.07	198.65	139	1.55	0.013	0.012	1.00
8+28	201.02	368.4	0.07	201.09	155	1.79	0.011	0.012	2.00
0+92									2.40
									0.01
									2.01
									195.41
									192.55
									0.97
									0.01
									197.82
									192.68
									2.40
									0.01
									2.01
									201.06

When column 13 is equal to column 14 there is no change in balance sheet I for that year.

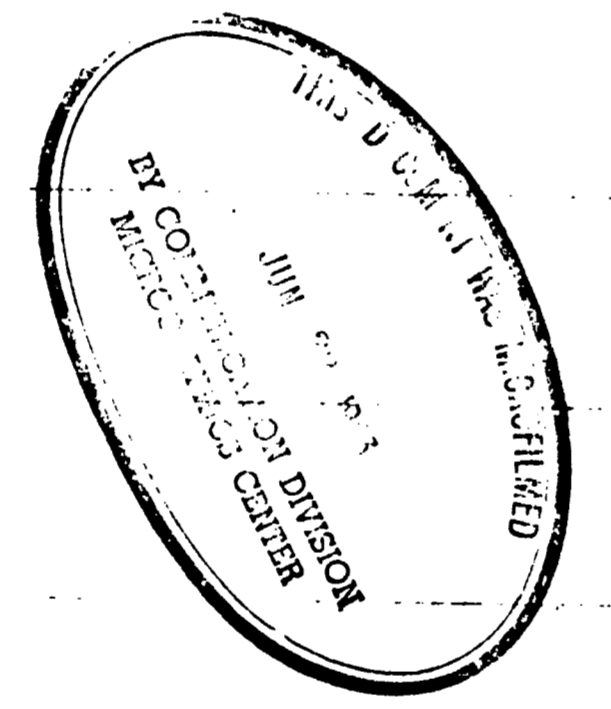

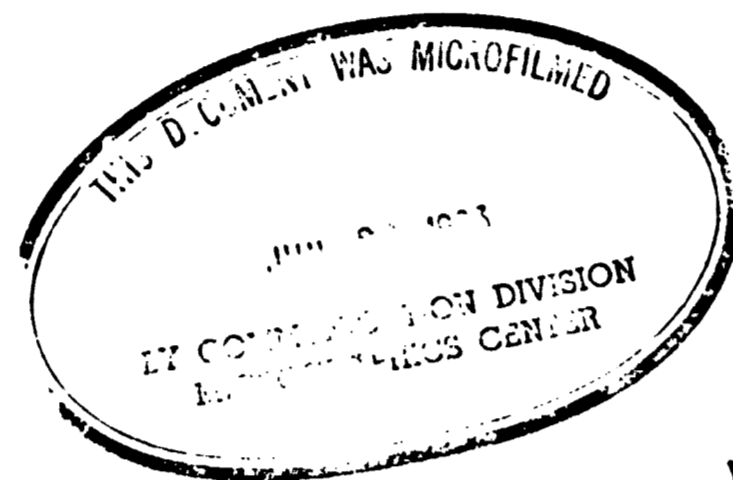

For: Jack White  
or  
Art Rose

From Richard S. Buck  
13007 Chalfont Ave  
Ft. Washington MD 20744  
tel: (W) 287-0392  
(H) 292-5612

Surveyor: A. Wayne Wilkerson  
tel: 855-8272

Richard S. Buck  
 Glendale Forest

3+25	195.02	303.4	0.11	195.55	1.66	2.01	0.015	0.013	3.25	0.01	195.41
4+26	192.48	419.8	0.06	194.04	1.21	1.76	0.009	0.012	1.01	0.01	192.55
5+28	197.44	370.7	0.071	197.51	1.724	2.047	0.010	0.0095	1.02	0.01	197.52
6+28	198.58	382.9	0.07	198.65	1.39	1.55	0.013	0.012	1.00	0.01	198.68
8+28	201.02	346.4	0.07	201.09	1.55	1.79	0.011	0.012	2.00	0.01	201.04

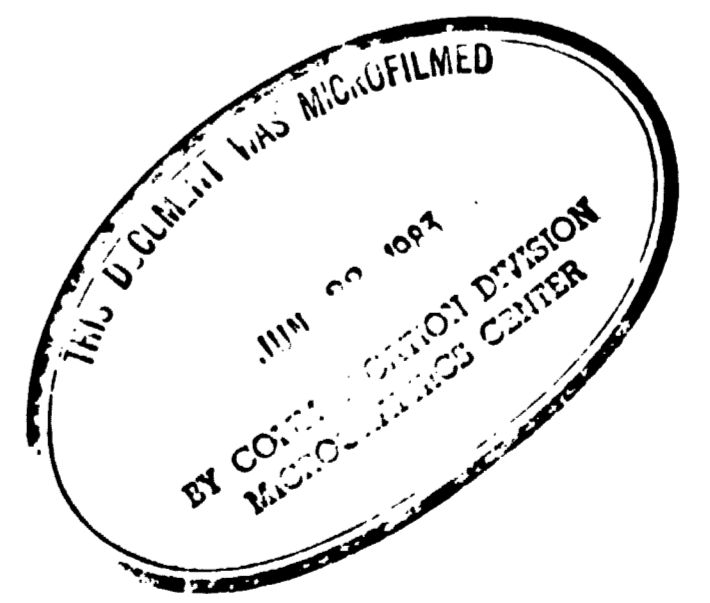

Richard S. Buck  
 Glendale Forest

0+00	191.04	398.2	0.06	191.10	1.52		0.011	0.011	Search & forchival depth checks		
3+25	195.22	363.4	0.11	195.33	1.68	2.01	0.015	0.013	3.65	4.30	0.01 195.41
4+26	196.48	419.8	0.06	196.54	1.61	1.96	0.009	0.012	1.01	1.21	0.01 196.55
5+28	197.44	398.7	0.06	197.50	1.52	1.75	0.010	0.010	1.02	1.02	0.01 197.57
6+28	198.58	382.9	0.07	198.65	1.39	1.55	0.013	0.012	1.00	1.16	0.01 198.67
8+28	201.02	346.4	0.07	201.09	1.55	1.79	0.011	0.012	2.00	2.40	0.01 201.04

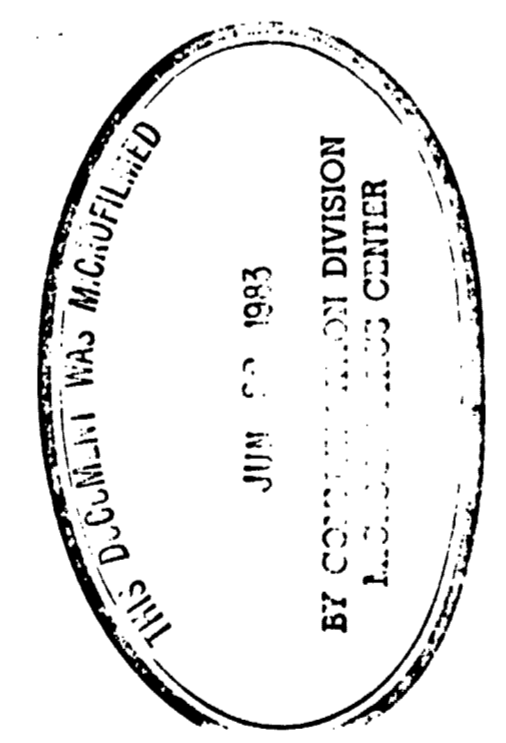
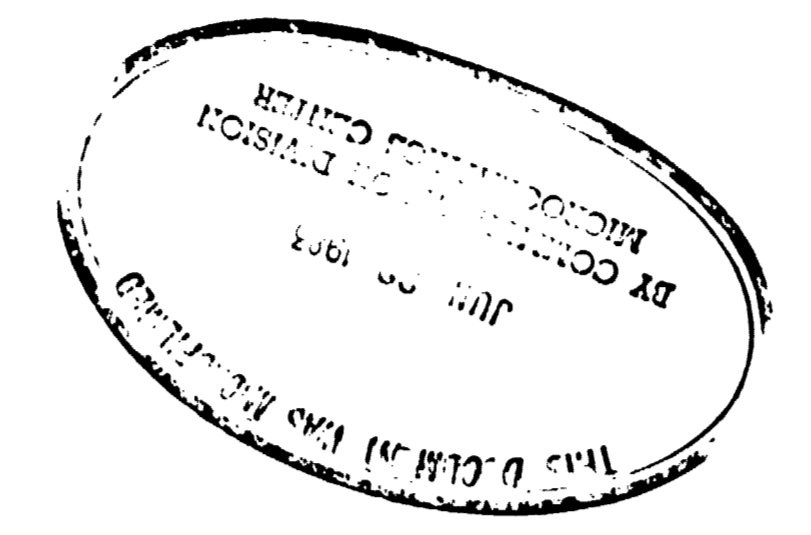

When you see  
 5 F 0.2 4+26  
 on a record in a  
 see sheet 1 for  
 on 45.

FINAL SURVEY	BY	DATE
NOTED		
REMARKS		
NO.		

ORIGINAL SURVEY	BY	DATE
NOTED		
REMARKS		
NO.		

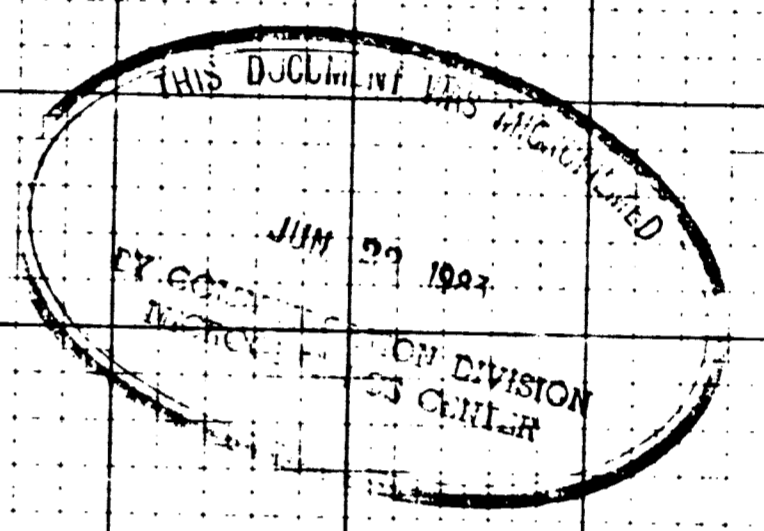
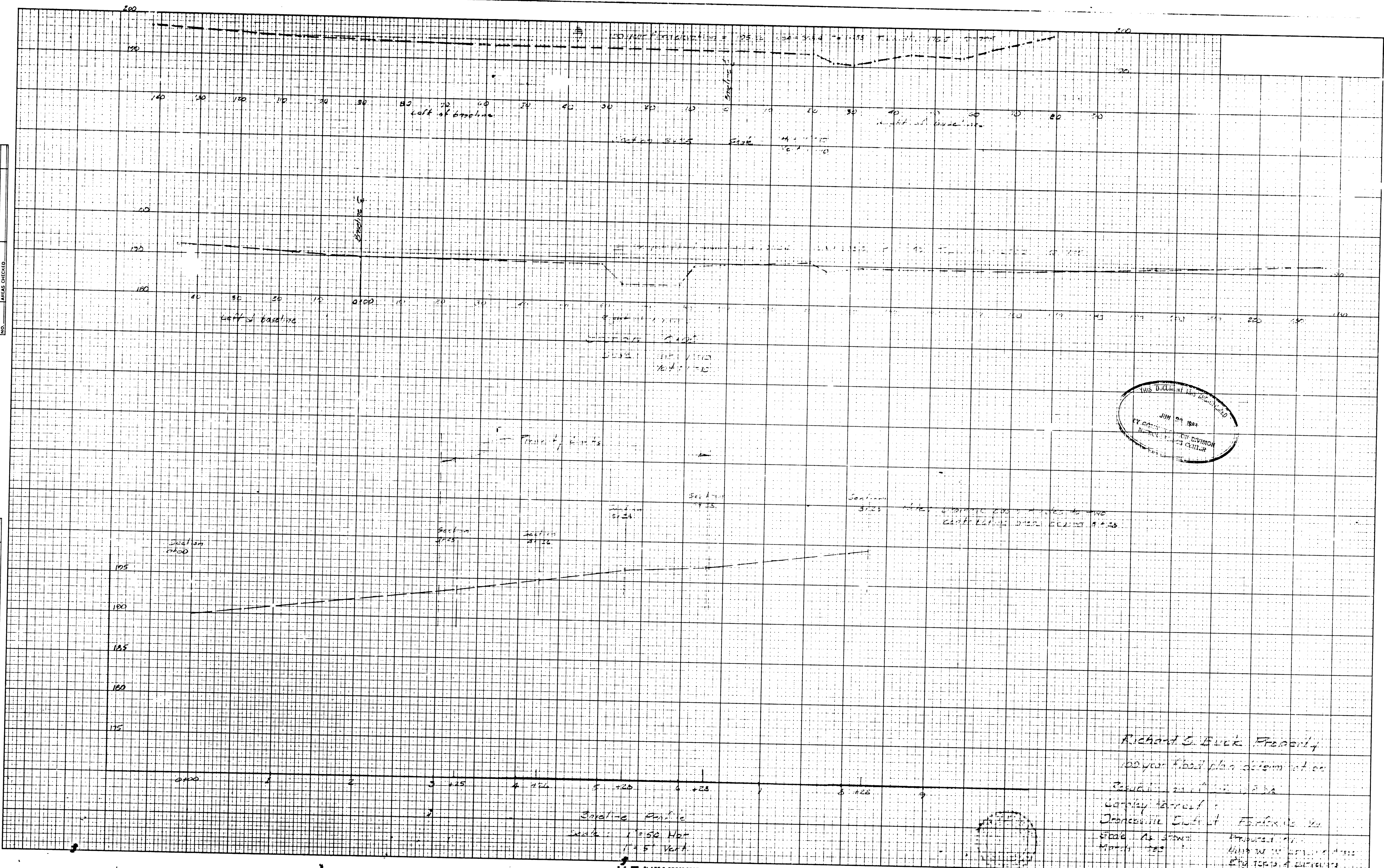

Richard S. Buck Property  
 100 year Flood plain determination  
 Section 1  
 Section 2  
 Section 3  
 State of Mississippi  
 Division of Highways

K&E PLATE 3 CROSS SECTION  
 48 7072 MADE IN U.S.A.

Sheet 2 of 2



DATE	
BY	
FINAL SURVEY NOTE BOOK NO.	
DUPLICATED SURVEY NOTE BOOK NO.	
AREAS CHECKED	

DATE	
BY	
ORIGINAL SURVEY NOTE BOOK NO.	
DUPLICATED SURVEY NOTE BOOK NO.	
AREAS CHECKED	

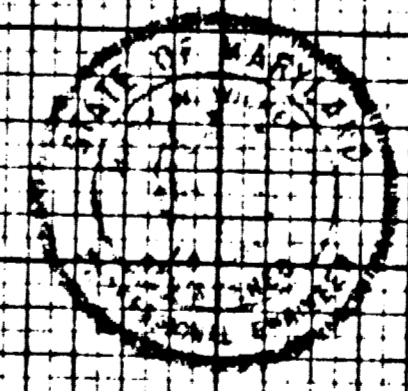
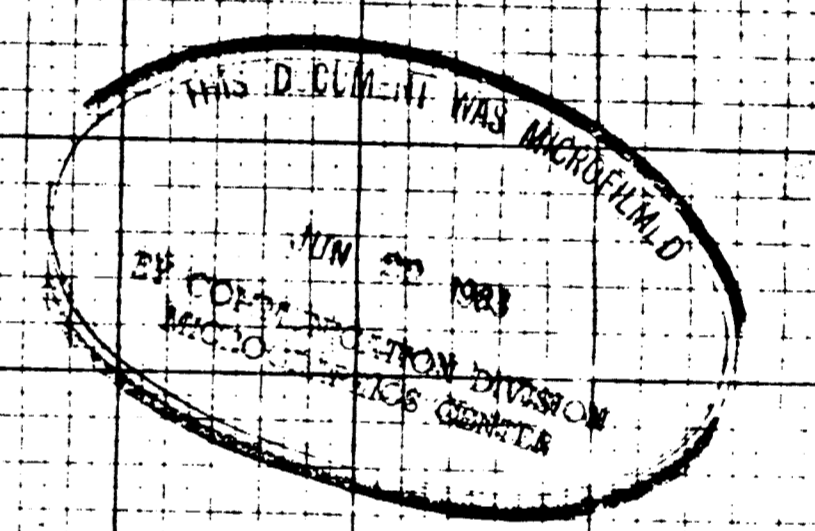
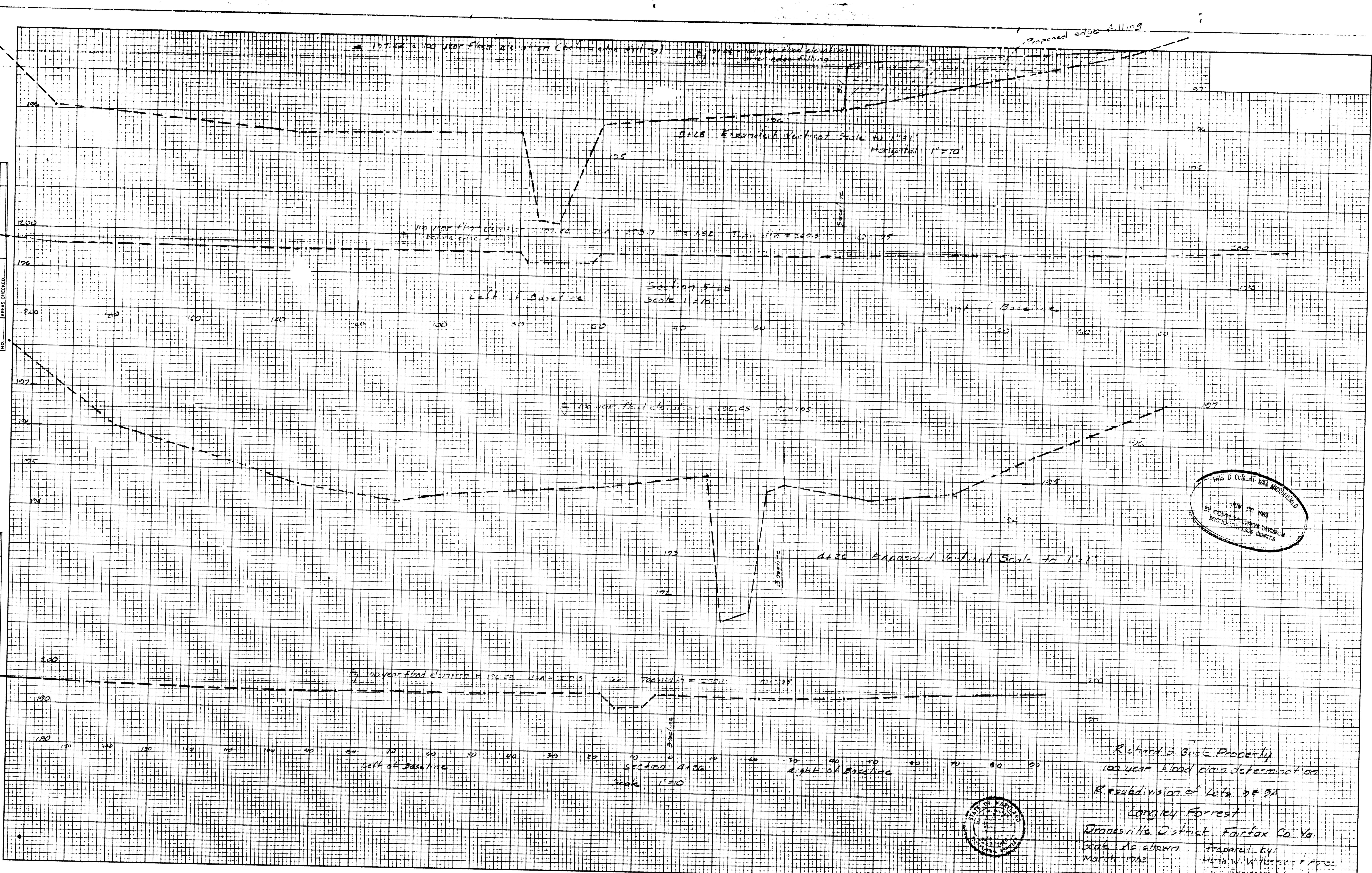

Richard S. Bink Property  
 100 year flood plan determination  
 Resubdivision of Lots 28 & 31  
 Langley Forest  
 Dinwiddie District, Fairfax Co. Va.  
 Scale As shown  
 March 1982  
 Prepared by:  
 Hight W. Berger & Assoc.  
 Civil Engineers & Land Surveyors  
 301 S. ...  
 ASSESSORS

FINAL SURVEY  
 SURVEYED BY  
 PHOTOGRAPHED BY  
 NOTE BOOK NO.  
 ATLAS CHECKED BY  
 NO.

ORIGINAL SURVEY  
 SURVEYED BY  
 PHOTOGRAPHED BY  
 NOTE BOOK NO.  
 ATLAS CHECKED BY  
 NO.

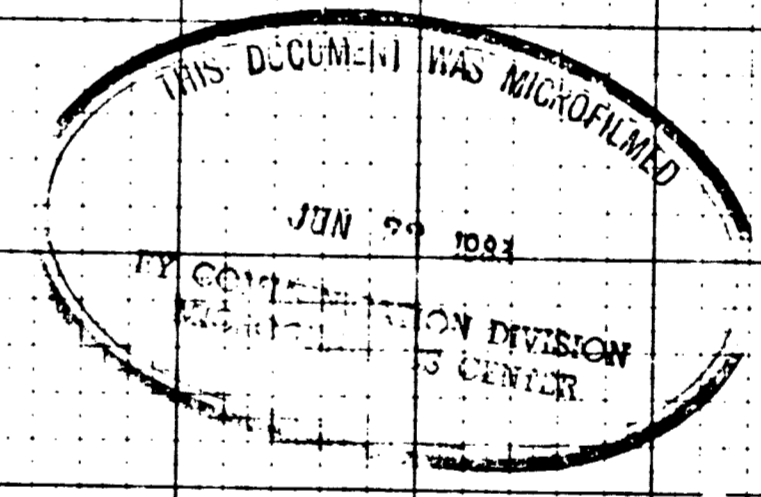
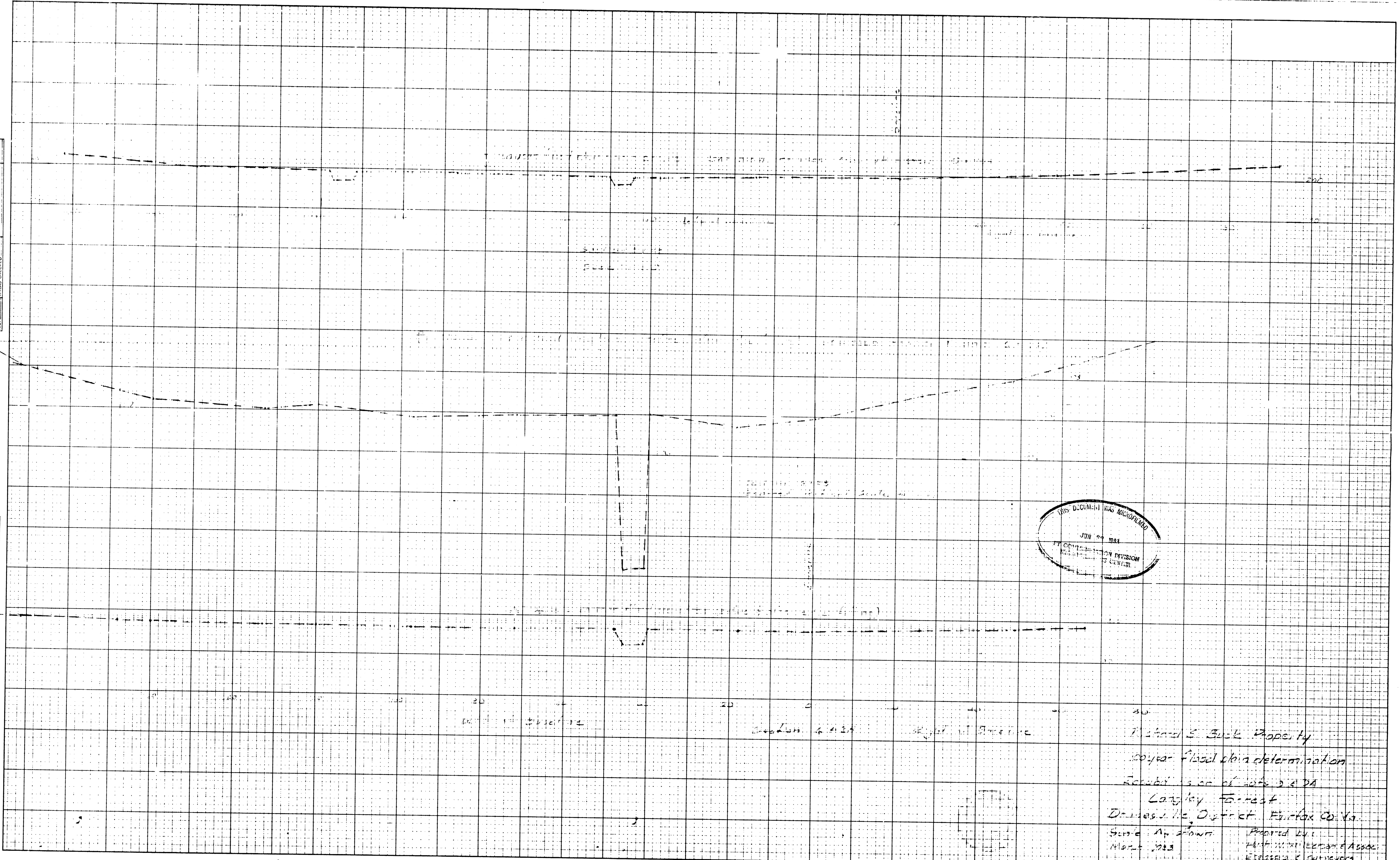

Richard S. Buck Property  
 100-year flood plain determination  
 Recubitation of water side DA  
 Langley Forest  
 District 1, District 2, Fairfax Co. Va.  
 Surveyed by  
 March 1983  
 Richard S. Buck  
 Richard S. Buck & Assoc.  
 Engineers & Surveyors  
 Dunbar, Md. 20754  
 301-2532 855-8272

K&E PLATE 3 CROSS SECTION  
 EQUIP. & SUPPLY CO.  
 48 7072 MADE IN U.S.A.

Sheet 3 of 3