

Burke – Springfield Center for Active Adults

Information Sessions

April 16, 2025 (Pohick Library)

April 21, 2025 (Virtual)



Fairfax County
**Neighborhood and
Community Services**



Agenda

Welcome & Introductions

Overviews

- Neighborhood and Community Services
- Center Without Walls
- Facility Overview
- Programming Opportunities

ServiceSource Program Review

Participant Engagement

Questions and Answers (Q&A)



NCS Overview

Neighborhood and Community Services (NCS) promotes the well-being of individuals, families and communities by providing a variety of recreation, educational and developmental programs and services; by facilitating community engagement to identify areas of need and enhance countywide capacity for serving those needs; and by connecting residents with a continuum of county- and community-based resources that promote equity and create positive outcomes for people of all ages and abilities.

Our mission is to partner with communities, families and individuals to provide opportunities to access a continuum of resources that promote equity and create positive outcomes for people of all ages and abilities.

Our vision is to see connected communities where all individuals and families are supported and empowered to thrive.

Programs: Early Childhood Programs and Services; Inclusive Support Services; Coordinated Services Programming; Athletics and Community Use; SACC, Community, Teen and Senior Centers; Therapeutic Recreation Services; Neighborhood Initiatives



Center Without Walls (CWOW) Overview

Burke-West Springfield Senior Center Without Walls:

Established in 2009, the Burke-West Springfield CWOW presents programs and activities in community centers, libraries and houses of worship.

Huntsman Square Location:

A new home with a new name: the **Burke-Springfield Center for Active Adults** will transition the program to a brick-and-mortar facility.

“This is a provisional site for programming and plans are moving forward for a full community center in the Burke Springfield area.”



Facility Overview

Location:

7541 Huntsman Blvd, Springfield, VA 22151

Scope:

- ❖ Interior tenant reconfiguration and renovation
- ❖ Approximately 8,250 net square feet
- ❖ Incorporate sustainable strategies

Features:

- ❖ Multipurpose Rooms for recreational programming and community activities
- ❖ Accessible design for all ages
- ❖ Offices and restrooms

Project Schedule

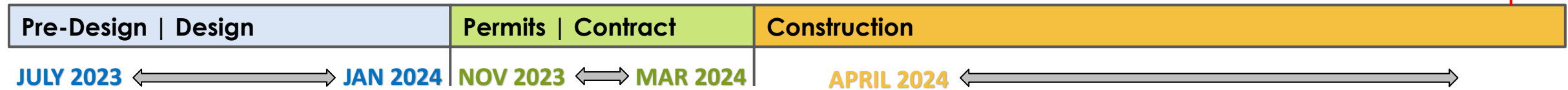

BSCAA Mall Entry/Front Parking Lot



Location Entrance

BSCAA Outdoor Signage



Views

BSCAA Indoor Signage



Facility Floor Plan

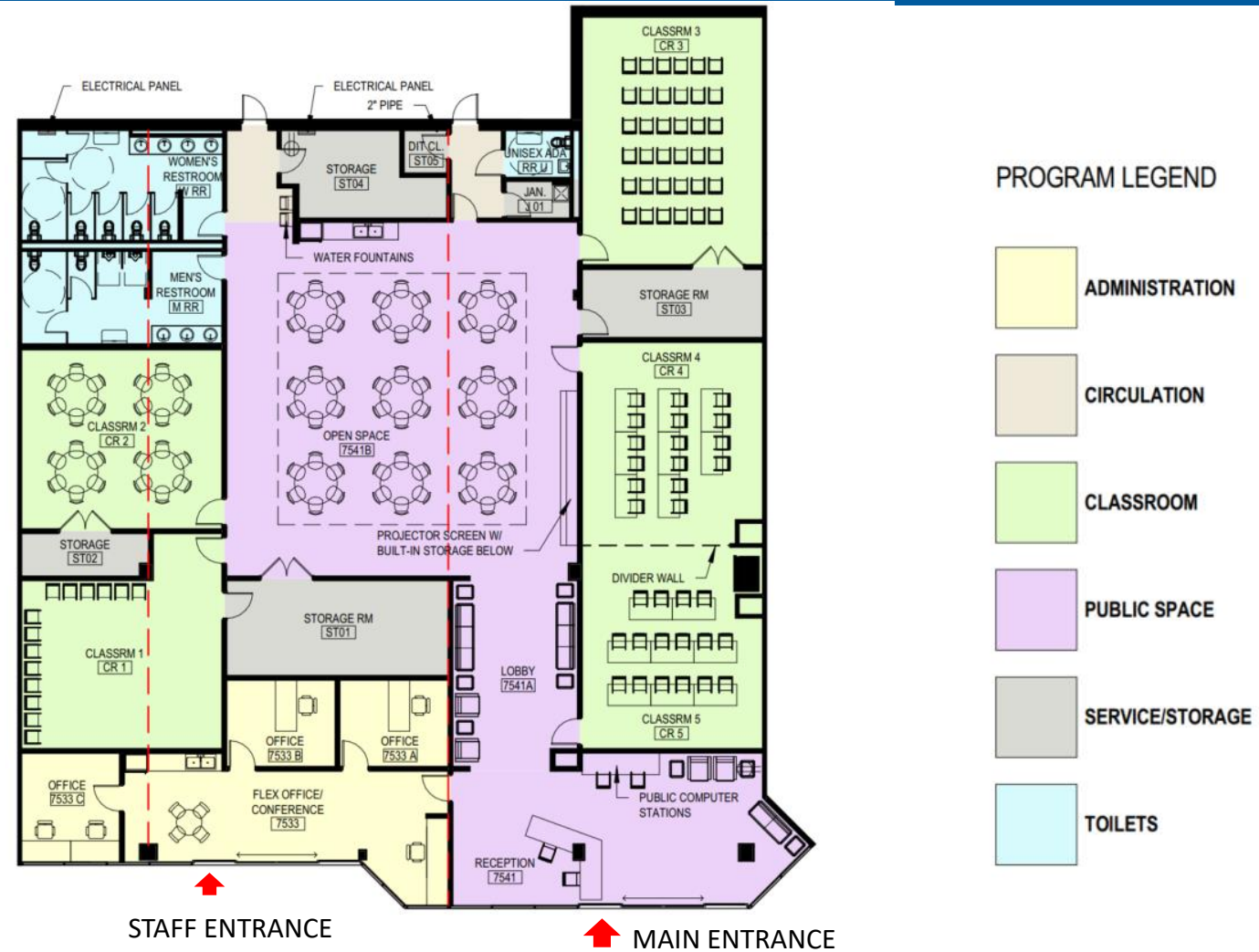

Program Classes



ZUMBA

Tai Chi

Pilates

Ukulele

Chair
Fitness

Tabletop
Games



ServiceSource Huntsman Community Integration Program



Huntsman Community Integration Program

An LTCIS Program of Service Source

ServiceSource: Mission, Vision, and Values

Mission – The mission of ServiceSource and its affiliates is to build inclusive communities by facilitating services, resources, and partnerships to support people with disabilities, their families, caregivers, and community members.

Vision – We envision communities that are inclusive and welcoming of the full diversity of their members of all abilities, in all aspects of community participation.

Values - In all that we do, we recognize that we are a bridge to the community. Our values compromise iBridge:



Overview

In FY 2024, ServiceSource:

- Served 35,000+ people with disabilities across all programs
- 2,150+ people with disabilities in direct or facilitated employment
- Placed 1,775+ people with disabilities with third-party employers
- Served 800+ people through long-term community integration services programs

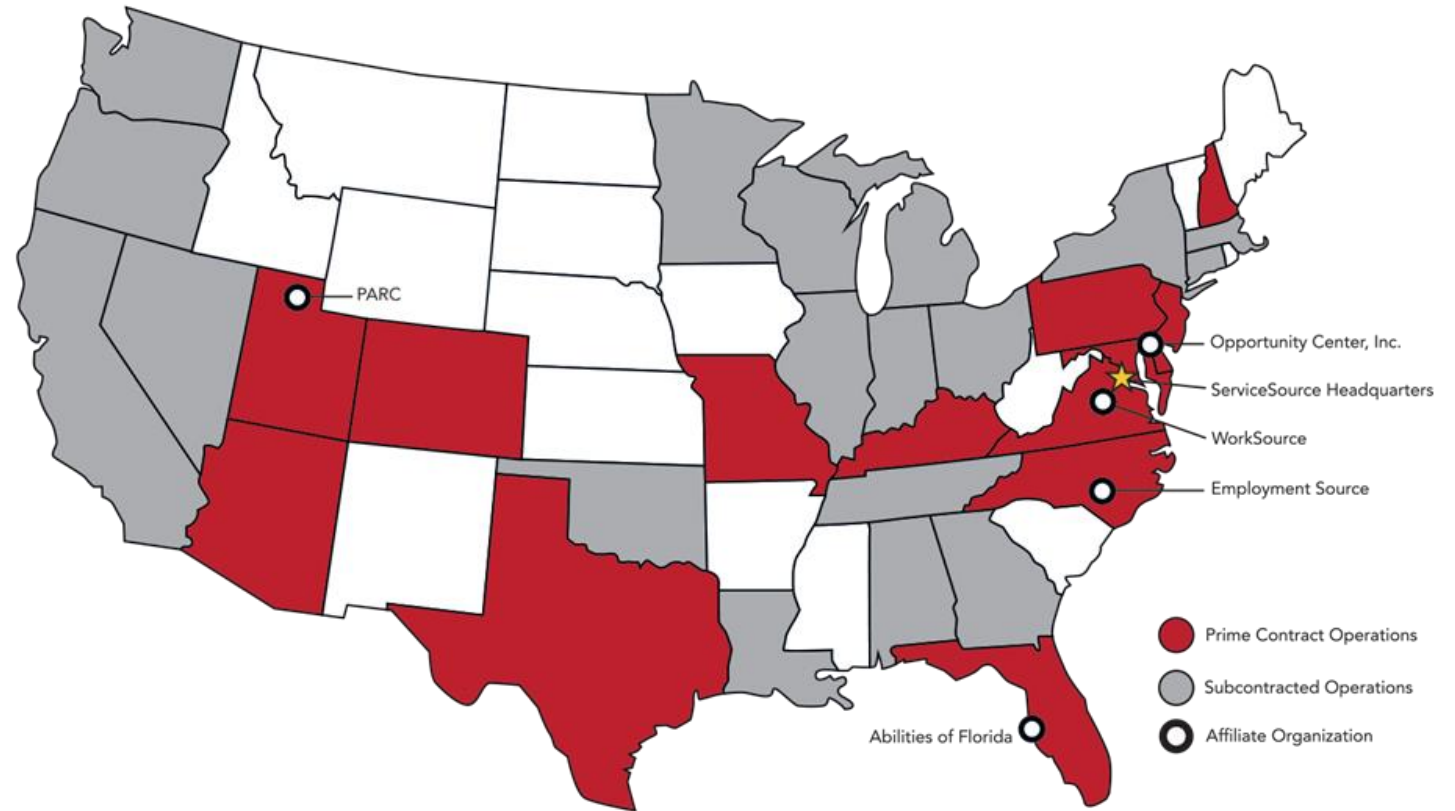

Proprietary & Business Information

Long-Term and Community Integration Services (LTCIS)

More than 800 individuals with disabilities participate annually in Virginia, North Carolina, Delaware, and Utah

In Virginia:

- Serve 600+ individuals in (soon to be) 14 different programs across Northern Virginia
- Focus on providing person-centered activities in a safe environment.
- Services are tailored to the interests and needs of the individuals.
- Customized, person-centered program options
- Maximize community integration and personal choice



Individuals from Service Source touring the U.S. Capitol

Proprietary & Business Information

Huntsman Community Integration Program

This program:

- Serves 10 participants and employs 3 staff
- Program Hours: 9 a.m. - 3:30 p.m.
- This program, through person-centered supports, will maximize individual choice and community integration.
- Utilize Service Source vans to transport participants to daily, planned community activities.



Proprietary & Business Information

Participant Input

What additional activities would you like to see in the Burke/Springfield Center for Active Adults for Older Adults?

Participant Input

What kinds of programming would you like to see in the Burke/Springfield Center for Active Adults for Youth, Teens, and Families?

Other Ways To Provide Input

- The April 2025 Presentation will be posted online on April 17.
- Public Comment will be accepted via an online form from April 17–30.
- To access the public comment form, scan the QR code or visit <https://publicinput.com/bscad>



Questions and Answers (Q&A)

Upcoming Virtual Information Session:

MONDAY, APRIL 21, 2025 – 6:30 – 8 p.m.

<https://us02web.zoom.us/j/82240662357>

This presentation will be uploaded to the project website:

Project website: www.fairfaxcounty.gov search BSCAA

Email for questions: NCS@fairfaxcounty.gov

Thank you for joining us!