

PROJECT MANAGER - MARK VANZANDI, (703) 877-5600 - TDD of Fairfax County  
 SURVEYED BY DATE - FAIRFAX COUNTY DOT SURVEY DEPARTMENT, AUGUST 4, 2016 (703) 877-5600  
 DESIGN BY - EMMANUEL ABRANYOS, P.E., (571) 218-1000 - JACOBS  
 SUBSURFACE UTILITY BY DATE - ACCUMARK, 1-800-542-2990, 08/21/17

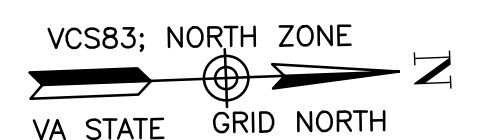
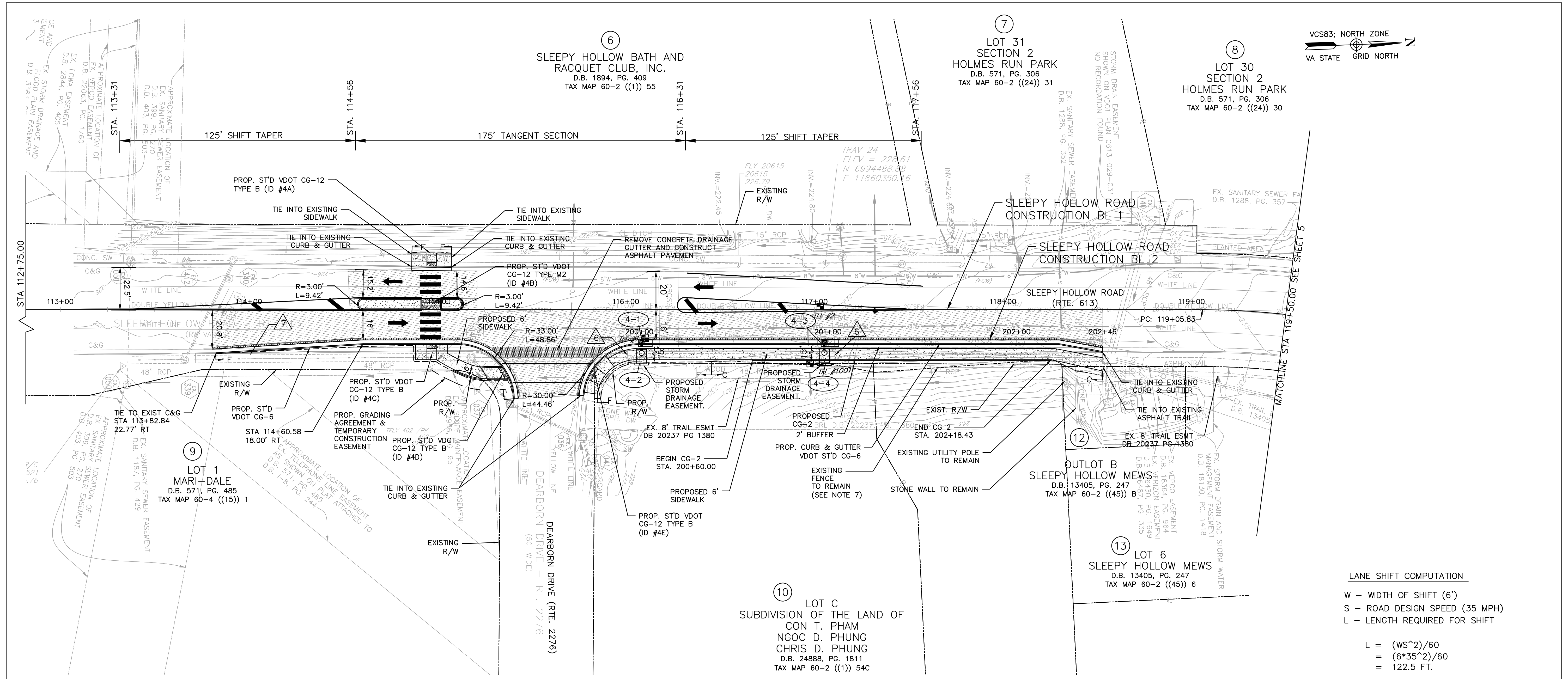

PLAN VIEW  
 SCALE: 1"=25'

LANE SHIFT COMPUTATION  
 W - WIDTH OF SHIFT (6')  
 S - ROAD DESIGN SPEED (35 MPH)  
 L - LENGTH REQUIRED FOR SHIFT  
 $L = (WS^2)/60$   
 $= (6 \times 35^2)/60$   
 $= 122.5 \text{ FT.}$   
 MINIMUM TANGENT SECTION LENGTH  
 BETWEEN TWO CONSECUTIVE SHIFT  
 TAPER 150 FEET.

LEGEND

- CLASS A4 CONCRETE
- ASPHALT DRIVEWAY
- DETECTABLE WARNING SURFACE
- MILL AND OVERLAY
- FULL DEPTH PAVEMENT
- PROP. R/W
- PROP. TEMP. CONST. EASEMENT

DRAINAGE LEGEND

- DRAINAGE TOP TO BE ADJUSTED
- DRAINAGE STRUCTURE TO BE REMOVED
- DRAINAGE STRUCTURE TO BE ABANDONED
- DRAINAGE PIPE TO BE REMOVED
- DRAINAGE PIPE TO BE ABANDONED
- DRAINAGE STRUCTURE TO BE MODIFIED
- DRAINAGE PIPE TO BE INSPECTED
- DRAINAGE STRUCTURE TO BE CAPPED UNDER PAVEMENT

NOTES:

- 1.) VDOT SHALL MAINTAIN PROPOSED CONCRETE SIDEWALK, CURB RAMPS, AND ENTRANCE GUTTERS.
- 2.) PROPOSED CONCRETE SIDEWALK AND CURB RAMPS SHALL DRAIN TOWARDS ROADWAY AT 2% MAX CROSS SLOPE.
- 3.) CONTRACTOR SHALL FULL DEPTH SAW CUT 1' INTO EXISTING ASPHALT PAVEMENT FOR THE INSTALLATION OF CURB & GUTTER AND/OR CURB RAMPS AND REPLACE ANY DISTURBED ASPHALT PAVEMENT WITH THE PAVEMENT SECTION PROVIDED ON TYPICAL SECTION SHEET 2C OR PROVIDE THE SAME PAVEMENT SECTION THICKNESS AS THE EXISTING PAVEMENT DEPTH.
- 4.) SEE SHEET 2D(1) TO 2D(5) FOR CURB RAMP DETAILS.
- 5.) SEE EROSION AND SEDIMENT CONTROL SHEETS FOR TREE REMOVAL.
- 6.) SEE SHEET 2D(1) FOR CURB RETURNS AND PEDESTRIAN REFUGEE ISLAND STATION & OFFSET AND ELEVATION.
- 7.) REMOVE AND RESET PORTION OF THE EXISTING WHITE FENCE FROM STATION 201+00 TO STATION 201+50 THAT IS IMPACTED BY GRADING.
- 8.) MANHOLES FRAMES AND COVER SHALL BE FLUSH WITH GRADE AND PROTECTED DURING CONSTRUCTION.

NOTES:

HORIZONTAL DATUM: VIRGINIA COORDINATE SYSTEM NORTH ZONE #451  
 VERTICAL DATUM: GEODETIC VERTICAL DATUM (NGVD), 1929

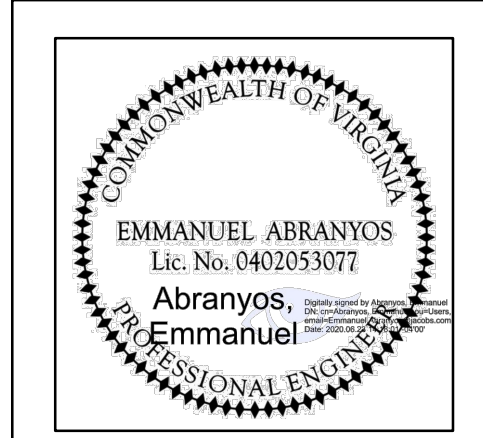
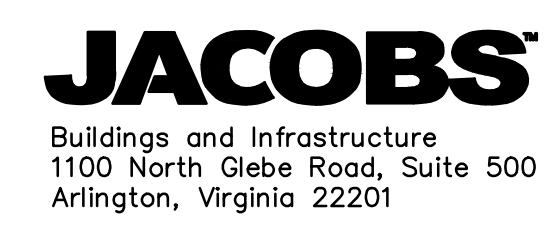

EMMANUEL ABRANYOS  
 2020.12.04  
 JACOBS  
 Arlington, Virginia  
 ROADWAY ENGINEER

EMERGENCY POLICE - FIRE - RESCUE 911 FAIRFAX COUNTY, VIRGINIA DEPARTMENT OF PUBLIC WORKS AND ENVIRONMENTAL SERVICES UTILITIES DESIGN & CONSTRUCTION DIVISION 12000 GOVERNMENT CENTER PARKWAY, SUITE 463 FAIRFAX, VA., 22035-0052				
OFFICE OF CAPITAL FACILITIES 703-324-5800		SLEEPY HOLLOW ROAD WALKWAYS PLAN SHEET		
CONTRACT NO. PROJECT NO. 2G40-088-028				
SCALE AS SHOWN	DESIGNED: E. ABRANYOS DRAFTED: A. PASCARELLI CHECKED: A. FARYAR	SHEET 4	FUND # 400-C40011	
R				
E				
V				
I				
S				
J				
O				
N				
S	Δ#	DESCRIPTION	BY	APPROVED DATE