

PROJECT MANAGER DENNIS MARSH, FAIRFAX COUNTY DOT, PE, T098775746  
 SURVEYED BY DATE COUNTY OF FAIRFAX, DEW, 07/2018  
 DESIGN BY KIMLEY-HORN AND ASSOCIATES, INC. 703-674-1300  
 SUBSURFACE UTILITY BY DATE COUNTY OF FAIRFAX, DEW, 07/2018

MATCHLINE STA. 212+00.00 / STA. 312+06.68 - SEE SHEET 12

REVISED	STATE	ROUTE	PROJECT	SHEET NO.
	VA.	655	0655-029-R57	9

DESIGN FEATURES RELATING TO CONSTRUCTION OR TO REGULATION AND CONTROL OF TRAFFIC MAY BE SUBJECT TO CHANGE AS DEEMED NECESSARY BY THE DEPARTMENT

Kimley - Horn  
Reston, Virginia  
Hydraulic Engineer

Kimley - Horn  
Reston, Virginia  
Roadway Engineer

DAVID A. GREEN  
D.B. 24565, PG. 1981  
56-4(15)4  
0.731 AC

CLARA MARKLEY COFFMAN, TRUSTEE OF THE RALPH RINKER COFFMAN AND CLARA MARKLEY COFFMAN FAMILY TRUST, A REVOCABLE TRUST DATED FEBRUARY 15, 1991 AND AS AMENDED BY THAT CERTAIN FIRST AMENDMENT DATED DECEMBER 7, 1998 AND SECOND AMENDMENT DATED OCTOBER 1, 2005  
 D.B. 20201, PG. 786  
 TAX MAP 56-4 (11) 29  
 4.9932 AC

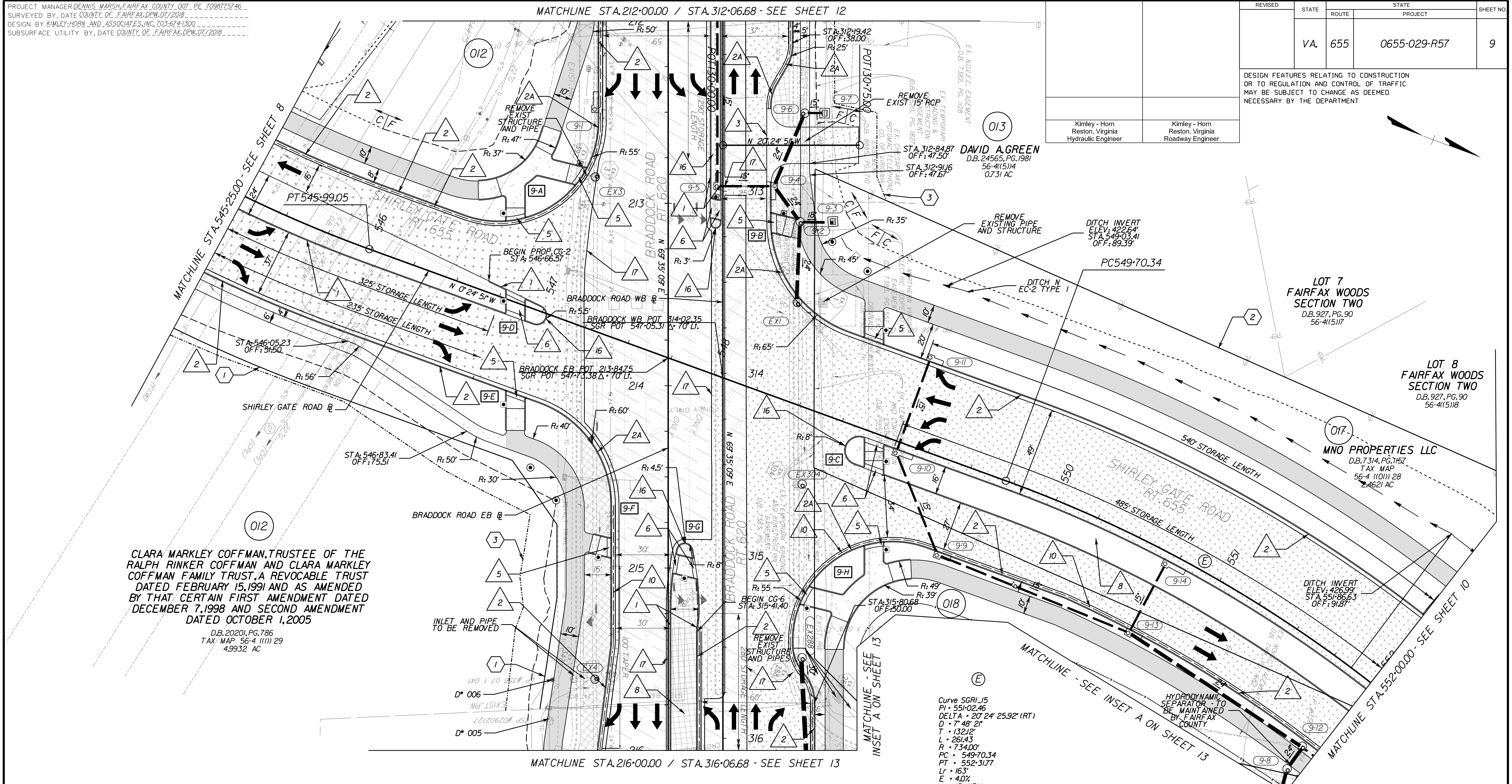

KEY LEGEND			
1	6' Curb, S'd, CG-2 Req'd	11	Pavement Edgedrain (Non-Perforated), S'd, UD-4 Req'd
1A	6' Curb, Rad, CG-2 Req'd	12	Existing Pipe to Be Cleaned Out
2	6' Curb & Gutter, S'd, CG-6 Req'd.	13	Crossdrain, S'd, CD-2 Req'd
2A	6' Curb & Gutter, Rad, S'd, CG-6 Req'd.	14	Pavement Widening, S'd, WP-2 Req'd.
3	Entrance Gutter, S'd, CG-9D Req'd.	15	4" Curb, S'd, CG-3 Req'd.
4	S'd, CG-12, Detectable Warning Surface - Type A Req'd	16	Solid Concrete Raised Median Strips, S'd, MS-1A Req'd.
5	S'd, CG-12, Detectable Warning Surface - Type B Req'd	17	Full Depth Sawcut
6	S'd, CG-12, Detectable Warning Surface - Type MI Req'd		
7	Hydr. Cement Conc Sidewalk Req'd.		
8	Raised Grass Median Strips, S'd, MS-2 Req'd.		
9	Pipe Underdrain for Grass Medians, S'd, UD-2 Req'd		
10	Pavement Edgedrain, S'd, UD-4 Req'd		

.....	Denotes Edge of Graded Shoulder	C	Denotes Construction Limits in Cuts
-	Denotes Graded V Ditch	F	Denotes Construction Limits in Fills
▨	Denotes Asphalt Shared Used Path	-x-	Denotes S'd FE-CL
▩	Denotes Proposed Concrete Items	■	Denotes Push Button and Signal Pole
▧	Denotes Proposed Full Depth Pavement		
▦	Denotes Proposed Pavement Removal		
▨	Denotes Proposed Mill and Overlay or Wedge Overlay		
▩	Denotes Stormwater Management Access Road		

REFERENCES (PROFILES, DETAIL & DRAINAGE DESCRIPTION SHEETS, ETC.)	
PROFILES	3A-14A
TYPICAL SECTIONS	2A(1)-2A(9)
ALIGNMENT DATA	1G(1)-1G(7)
CROSS SECTIONS	XI-X123

PRE - FINAL PLANS

THESE PLANS ARE UNFINISHED AND UNAPPROVED AND ARE NOT TO BE USED FOR ANY TYPE OF CONSTRUCTION OR THE ACQUISITION OF RIGHT OF WAY.

SCALE	PROJECT	SHEET NO.
0 25' 50'	0655-029-R57	9

Curve SGR1.15  
 PI = 551+02.46  
 DELTA = 20° 24' 25.92" (RT)  
 D = 7' 48" 21"  
 T = 132.12'  
 L = 261.43'  
 R = 734.00'  
 PC = 549+70.34  
 PT = 552+31.77  
 Lr = 163'  
 E = 4.0%  
 V = 45 MPH

INSET A ON SHEET 13

MATCHLINE STA. 216+00.00 / STA. 316+06.68 - SEE SHEET 13

MATCHLINE - SEE INSET A ON SHEET 13

MATCHLINE STA. 552+00.00 - SEE SHEET 10

MATCHLINE STA. 545+25.00 - SEE SHEET 8