

REVISED	STATE	ROUTE	STATE	PROJECT	SHEET NO.
	VA.	655		0655-029-R57	13

DESIGN FEATURES RELATING TO CONSTRUCTION OR TO REGULATION AND CONTROL OF TRAFFIC MAY BE SUBJECT TO CHANGE AS DEEMED NECESSARY BY THE DEPARTMENT

Kimley - Horn
 Reston, Virginia
 Hydraulic Engineer

Kimley - Horn
 Reston, Virginia
 Roadway Engineer

COMMONWEALTH OF VIRGINIA
 GEORGE MASON UNIVERSITY
 D.B. 7302, PG. 1334
 TAX MAP 56-4 (111) 34
 84.86 AC

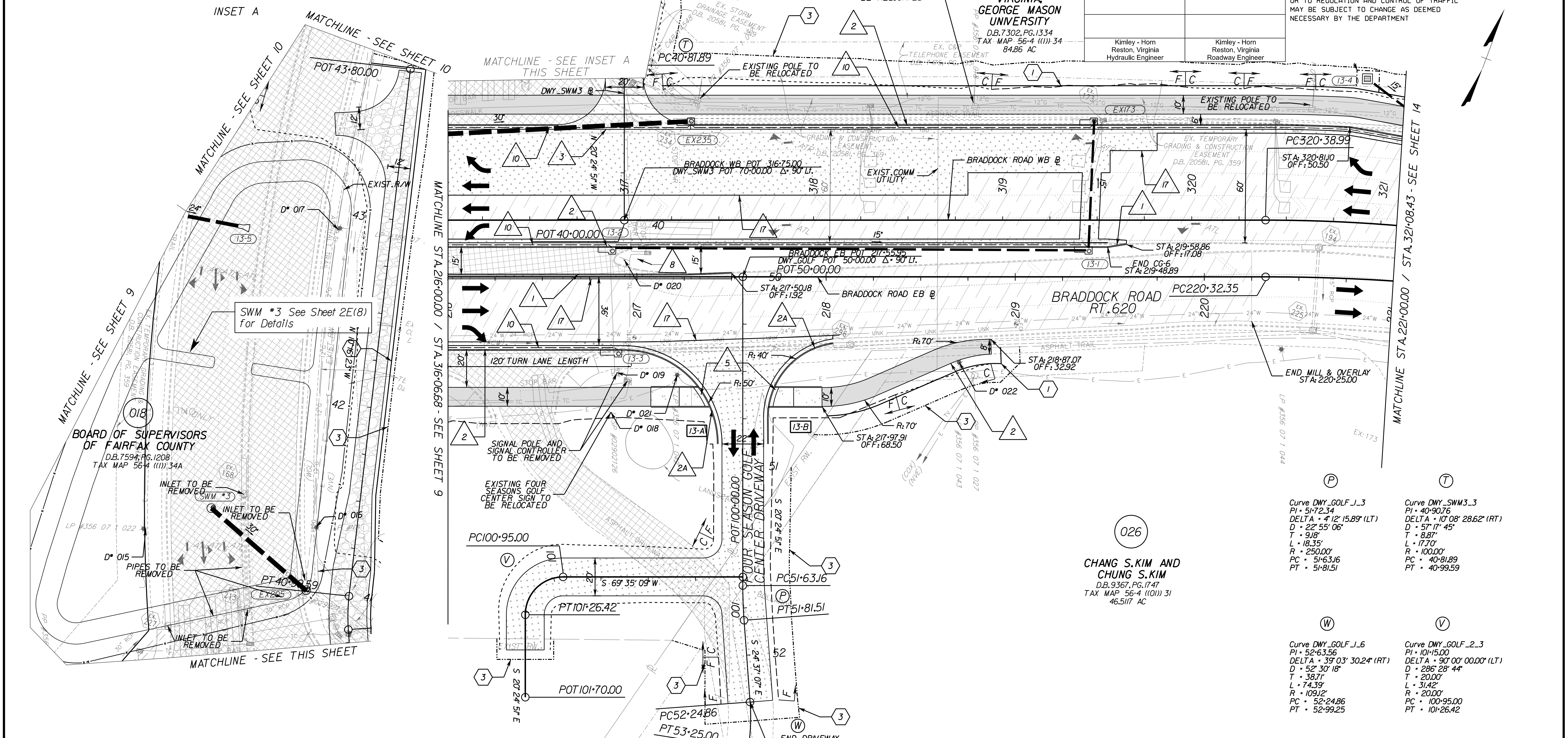

Curve DMY_GOLF_I_3
 PI • 40+90.76
 DELTA • 4° 12' 15.89" (LT)
 D • 57' 17" 45"
 T • 9.87'
 L • 17.70'
 R • 250.00'
 PC • 51+63.16
 PT • 51+81.51

Curve DMY_SWM3_3
 PI • 40+90.76
 DELTA • 10° 08' 28.62" (RT)
 D • 57' 17" 45"
 T • 8.87'
 L • 17.70'
 R • 100.00'
 PC • 40+81.89
 PT • 40+99.59

CHANG S. KIM AND
 CHUNG S. KIM
 D.B. 9367, PG. 1747
 TAX MAP 56-4 (101) 31
 46.517 AC

Curve DMY_GOLF_I_6
 PI • 52+63.56
 DELTA • 39° 03' 30.24" (RT)
 D • 52' 30" 18"
 T • 38.71'
 L • 74.39'
 R • 109.12'
 PC • 52+24.86
 PT • 52+99.25

Curve DMY_GOLF_2_3
 PI • 101+15.00
 DELTA • 90° 00' 00.00" (LT)
 D • 286' 28" 44"
 T • 20.00'
 L • 31.42'
 R • 20.00'
 PC • 100+95.00
 PT • 101+26.42

KEY LEGEND

- | | | | | |
|--|---|---|--|---|
| ▲ 6" Curb, S'd, CG-2 Req'd | ▲ 5 S'd, CG-12 Detectable Warning Surface - Type B Req'd | ▲ 11 Pavement Edgedrain (Non-Perforated), S'd, UD-4 Req'd | Denotes Edge of Graded Shoulder | ┌──┐ Denotes Construction Limits in Cuts |
| ▲ 1A 6" Curb, Rad, CG-2 Req'd | ▲ 6 S'd, CG-12 Detectable Warning Surface - Type MI Req'd | ▲ 12 Existing Pipe to Be Cleaned Out | → Denotes Graded V Ditch | └──┘ Denotes Construction Limits in Fills |
| ▲ 2 6" Curb & Gutter, S'd, CG-6 Req'd. | ▲ 7 Hydr. Cement Conc Sidewalk Req'd. | ▲ 13 Crossdrain, S'd, CD-2 Req'd | ▨ Denotes Asphalt Shared Used Path | —x— Denotes S'd FE-CL |
| ▲ 2A 6" Curb & Gutter, Rad, S'd, CG-6 Req'd. | ▲ 8 Raised Grass Median Strips, S'd, MS-2 Req'd. | ▲ 14 Pavement Widening, S'd, WP-2 Req'd. | ▩ Denotes Proposed Concrete Items | |
| ▲ 3 Entrance Gutter, S'd, CG-9D Req'd. | ▲ 9 Pipe Underdrain for Grass Medians, S'd, UD-2 Req'd | ▲ 15 4" Curb, S'd, CG-3 Req'd. | ▩ Denotes Proposed Full Depth Pavement | |
| ▲ 4 S'd, CG-12 Detectable Warning Surface - Type A Req'd | ▲ 10 Pavement Edgedrain, S'd, UD-4 Req'd | ▲ 16 Solid Concrete Raised Median Strips, S'd, MS-1A Req'd. | ▩ Denotes Proposed Pavement Removal | |
| | | ▲ 17 Full Depth Sawcut | ▩ Denotes Proposed Mill and Overlay or Wedge Overlay | |
| | | | ▩ Denotes Stormwater Management Access Road | |

REFERENCES
 (PROFILES, DETAIL & DRAINAGE DESCRIPTION SHEETS, ETC.)

- PROFILES 3A-14A
 TYPICAL SECTIONS 2A(1)-2A(9)
 ALIGNMENT DATA 1G(1)-1G(7)
 CROSS SECTIONS XI-X123

PRE - FINAL PLANS

THESE PLANS ARE UNFINISHED AND UNAPPROVED AND ARE NOT TO BE USED FOR ANY TYPE OF CONSTRUCTION OR THE ACQUISITION OF RIGHT OF WAY.

SCALE 0 25' 50'	PROJECT 0655-029-R57	SHEET NO. 13
--------------------	-------------------------	-----------------