

PROJECT: MANAGER DENNIS MARSH, FAIRFAX COUNTY, DOT PE 709875746
 SURVEYED BY: DATE COUNTY OF FAIRFAX, DPW, 07/2018
 DESIGN BY: KIMLEY-HORN AND ASSOCIATES, INC. 703-674-1300
 SUBSURFACE UTILITY BY: DATE COUNTY OF FAIRFAX, DPW, 07/2018

REVISED	STATE	ROUTE	STATE PROJECT	SHEET NO.
	VA.	655	0655-029-R57	10

DESIGN FEATURES RELATING TO CONSTRUCTION OR TO REGULATION AND CONTROL OF TRAFFIC MAY BE SUBJECT TO CHANGE AS DEEMED NECESSARY BY THE DEPARTMENT

Kimley - Horn Reston, Virginia Hydraulic Engineer	Kimley - Horn Reston, Virginia Roadway Engineer
---------------------------------------------------------	-------------------------------------------------------

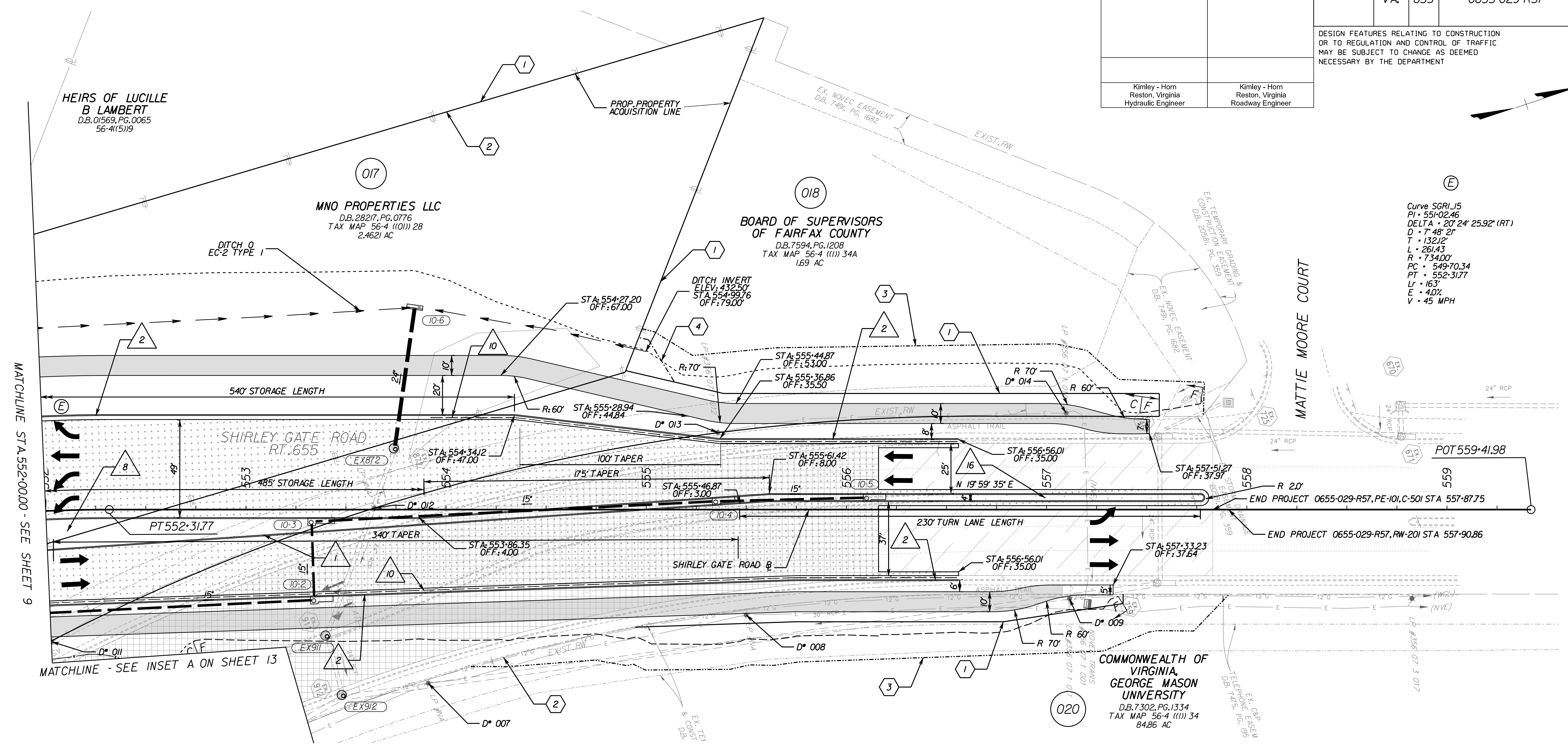

Curve SGR1_15
 PI = 551+02.46
 DELTA = 20° 24' 25.92" (RT)
 D = 7' 48" 21"
 T = 132.12'
 L = 261.43'
 R = 734.00'
 PC = 549+70.34
 PT = 552+31.77
 Lr = 163'
 E = 4.0%
 V = 45 MPH

KEY LEGEND

1 6' Curb, S'd, CG-2 Req'd	5 S'd, CG-12 Detectable Warning Surface - Type B Req'd	11 Pavement Edgedrain (Non-Perforated), S'd, UD-4 Req'd
1A 6' Curb, Rad, CG-2 Req'd	6 S'd, CG-12 Detectable Warning Surface - Type MI Req'd	12 Existing Pipe to Be Cleaned Out
2 6' Curb & Gutter, S'd, CG-6 Req'd.	7 Hydr. Cement Conc Sidewalk Req'd.	13 Crossdrain, S'd, CD-2 Req'd
2A 6' Curb & Gutter, Rad, S'd, CG-6 Req'd.	8 Raised Grass Median Strips, S'd, MS-2 Req'd.	14 Pavement Widening, S'd, WP-2 Req'd.
3 Entrance Gutter, S'd, CG-9D Req'd.	9 Pipe Underdrain for Grass Medians, S'd, UD-2 Req'd	15 4" Curb, S'd, CG-3 Req'd.
4 S'd, CG-12 Detectable Warning Surface - Type A Req'd	10 Pavement Edgedrain, S'd, UD-4 Req'd	16 Solid Concrete Raised Median Strips, S'd, MS-1A Req'd.
		17 Full Depth Sawcut

- Denotes Edge of Graded Shoulder
- Denotes Graded V Ditch
- Denotes Asphalt Shared Used Path
- Denotes Proposed Concrete Items
- Denotes Proposed Full Depth Pavement
- Denotes Proposed Pavement Removal
- Denotes Proposed Mill and Overlay or Wedge Overlay
- Denotes Stormwater Management Access Road
- Denotes Construction Limits in Cuts
- Denotes Construction Limits in Fills
- x- Denotes S'd FE-CL

- 1 Prop. R/W
- 2 Ex'ist. Property Line
- 3 Grading Agreement and Temp. Construction Easement
- 4 Perm. Drainage Easement

REFERENCES
 (PROFILES, DETAIL & DRAINAGE DESCRIPTION SHEETS, ETC.)

PROFILES	3A-14A
TYPICAL SECTIONS	2A(1)-2A(9)
ALIGNMENT DATA	1G(1)-1G(7)
CROSS SECTIONS	XI-X123

PRE - FINAL PLANS

THESE PLANS ARE UNFINISHED AND UNAPPROVED AND ARE NOT TO BE USED FOR ANY TYPE OF CONSTRUCTION OR THE ACQUISITION OF RIGHT OF WAY.

SCALE	PROJECT	SHEET NO.
0 25' 50'	0655-029-R57	10