

PROJECT: MANAGER DENNIS MARSH, FAIRFAX COUNTY, DOT, PE, 7098775746
 SURVEYED BY: DATE COUNTY OF FAIRFAX, DEW, 07/2018
 DESIGN BY: KIMLEY-HORN AND ASSOCIATES, INC., 703-674-1300
 SUBSURFACE UTILITY BY: DATE COUNTY OF FAIRFAX, DEW, 07/2018

REVISED	STATE	ROUTE	PROJECT	SHEET NO.
	VA.	655	0655-029-R57	5
DESIGN FEATURES RELATING TO CONSTRUCTION OR TO REGULATION AND CONTROL OF TRAFFIC MAY BE SUBJECT TO CHANGE AS DEEMED NECESSARY BY THE DEPARTMENT				
Kimley - Horn Reston, Virginia Hydraulic Engineer		Kimley - Horn Reston, Virginia Roadway Engineer		

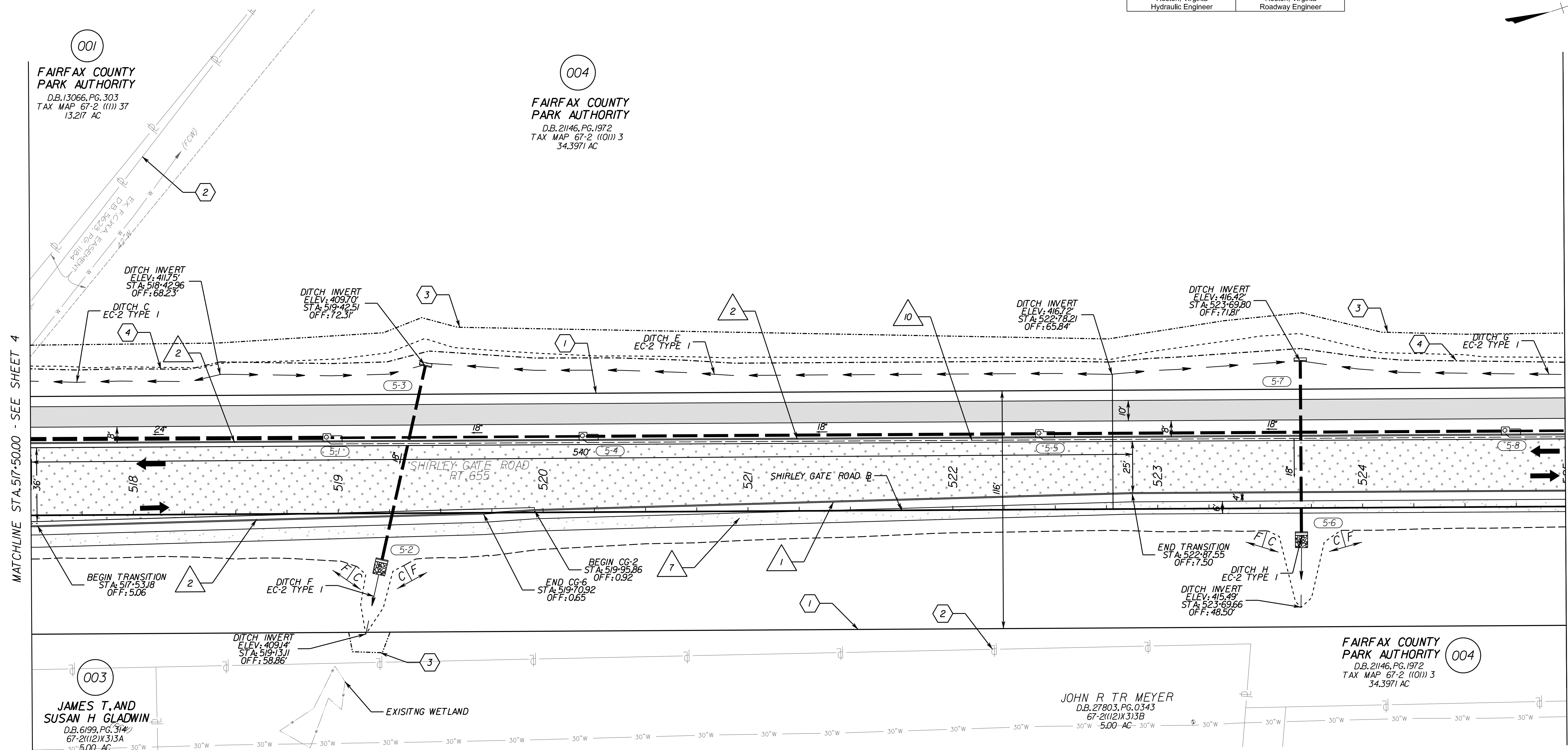
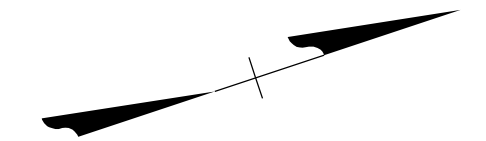

MATCHLINE STA. 517+50.00 - SEE SHEET 4

MATCHLINE STA. 525+00.00 - SEE SHEET 6

001
**FAIRFAX COUNTY
 PARK AUTHORITY**
 D.B. 13066, PG. 303
 TAX MAP 67-2 (111) 37
 13.217 AC

004
**FAIRFAX COUNTY
 PARK AUTHORITY**
 D.B. 21146, PG. 1972
 TAX MAP 67-2 (101) 3
 34.3971 AC

003
**JAMES T. AND
 SUSAN H. GLADWIN**
 D.B. 6199, PG. 314
 67-2(112)X313A
 30" 5.00 AC

JOHN R. TR. MEYER
 D.B. 27803, PG. 0343
 67-2(112)X313B
 5.00 AC

004
**FAIRFAX COUNTY
 PARK AUTHORITY**
 D.B. 21146, PG. 1972
 TAX MAP 67-2 (101) 3
 34.3971 AC

- KEY LEGEND**
- 1 6" Curb, S'd, CG-2 Req'd
 - 1A 6" Curb, Rad, CG-2 Req'd
 - 2 6" Curb & Gutter, S'd, CG-6 Req'd.
 - 2A 6" Curb & Gutter, Rad, S'd, CG-6 Req'd.
 - 3 Entrance Gutter, S'd, CG-9D Req'd.
 - 4 S'd, CG-12, Detectable Warning Surface - Type A Req'd
 - 5 S'd, CG-12, Detectable Warning Surface - Type B Req'd
 - 6 S'd, CG-12, Detectable Warning Surface - Type MI Req'd
 - 7 Hydr. Cement Conc Sidewalk Req'd.
 - 8 Raised Grass Median Strips, S'd, MS-2 Req'd.
 - 9 Pipe Underdrain for Grass Medians, S'd, UD-2 Req'd
 - 10 Pavement Edgedrain, S'd, UD-4 Req'd
 - 11 Pavement Edgedrain (Non-Perforated), S'd, UD-4 Req'd
 - 12 Existing Pipe to Be Cleaned Out
 - 13 Crossdrain, S'd, CD-2 Req'd
 - 14 Pavement Widening, S'd, WP-2 Req'd.
 - 15 4" Curb, S'd, CG-3 Req'd.
 - 16 Solid Concrete Raised Median Strips, S'd, MS-1A Req'd.
 - 17 Full Depth Sawcut

- Denotes Edge of Graded Shoulder
- Denotes Graded V Ditch
- Denotes Asphalt Shared Used Path
- Denotes Proposed Concrete Items
- Denotes Proposed Full Depth Pavement
- Denotes Proposed Pavement Removal
- Denotes Proposed Mill and Overlay or Wedge Overlay
- Denotes Stormwater Management Access Road
- C--- Denotes Construction Limits in Cuts
- F--- Denotes Construction Limits in Fills
- x- Denotes S'd FE-CL
- 1 Prop. R/W
- 2 Exst. Property Line
- 3 Grading Agreement and Temp. Construction Easement
- 4 Perm. Drainage Easement

REFERENCES
 (PROFILES, DETAIL & DRAINAGE DESCRIPTION SHEETS, ETC.)

PROFILES	3A-14A
TYPICAL SECTIONS	2A(1)-2A(9)
ALIGNMENT DATA	1G(1)-1G(7)
CROSS SECTIONS	XI-X123

PRE - FINAL PLANS

THESE PLANS ARE UNFINISHED AND UNAPPROVED AND ARE NOT TO BE USED FOR ANY TYPE OF CONSTRUCTION OR THE ACQUISITION OF RIGHT OF WAY.

SCALE	PROJECT	SHEET NO.
0 25' 50'	0655-029-R57	5